

DETAIL # :  
AVM-502-3002-C  
AVM System 502  
Aussie II  
VIEW TYPE:  
Cut Sheet

# Pavers on Concrete Substrate over AVM System 502 Aussie II Fluid Applied Waterproofing

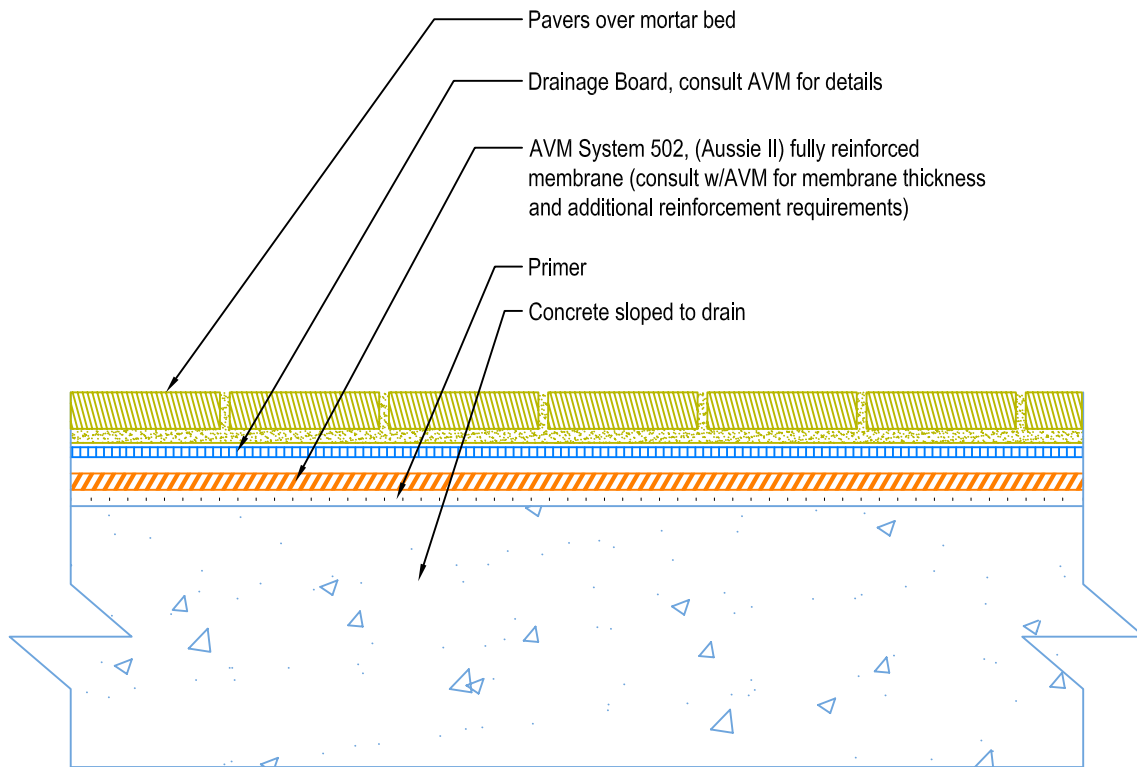

**Notes:**

1. Aussie II (AVM System 502) is a two-component, Water-Based Bitumen (Spray Applied) for Below-Grade, Lagging, Between-Slab, Planters, Roof-Gardens, Paver Systems and similar type Waterproofing.
2. For proper membrane thickness and appropriate protection and drainage, refer to AVM System 502, Aussie II's "Min Thickness Table"
3. Contact AVM if no drain board or protection board is specified