

DETAIL #:  
AVM-0520-0006-C

AVM SYSTEM 520

AUSSIE MEMBRANE 520

Retaining Walls  
Slab on Grade at Top of Footing  
AVM AUSSIE MEMBRANE 520  
Fluid Applied Waterproofing.

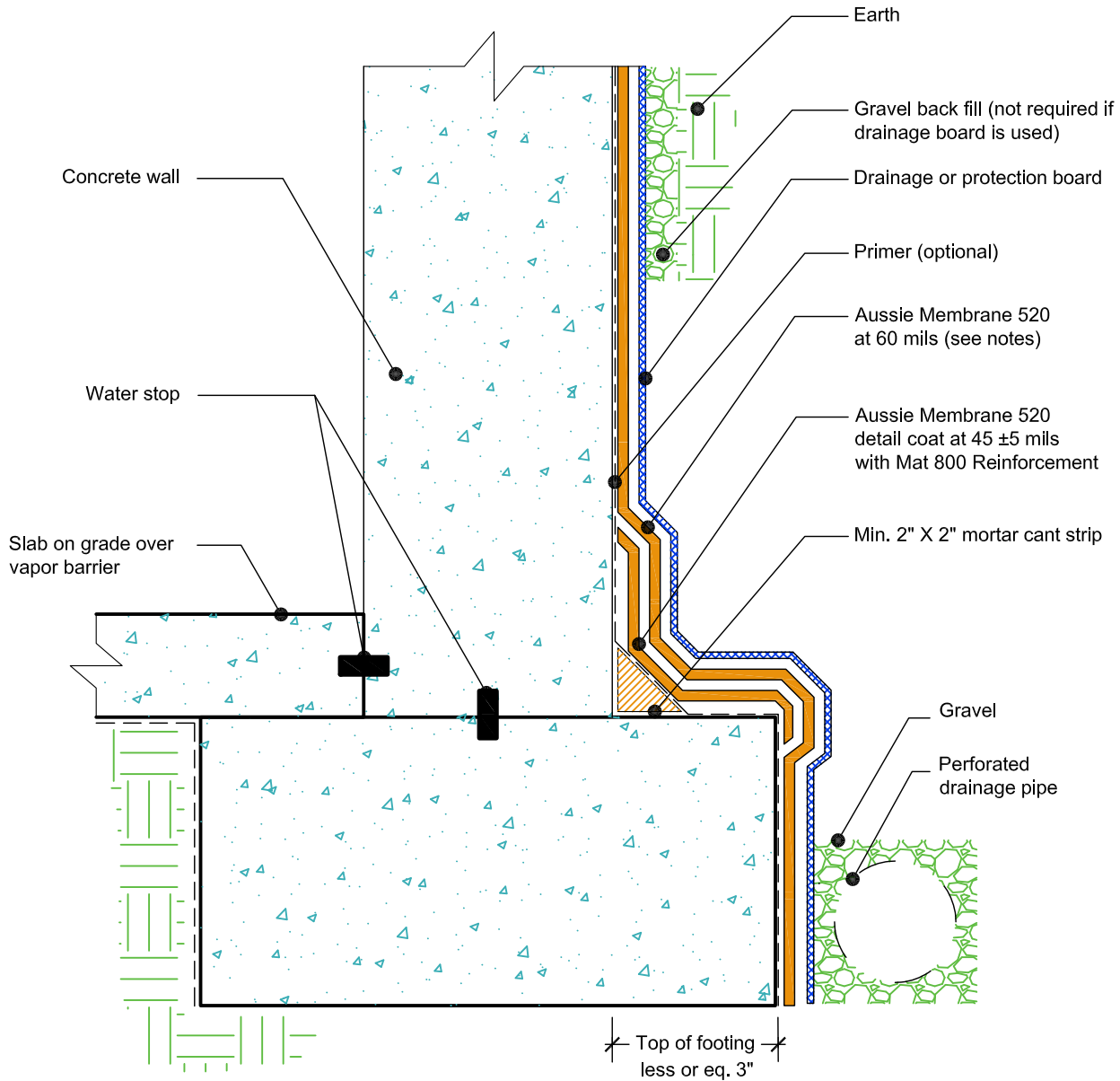

**NOTES:**

1. Aussie Membrane 520 is a Polyurethane liquid (Roller or Brush Applied) for Below-Grade, Between-Slab, Planters, Roof-Gardens and similar type Waterproofing.
2. For proper membrane thickness and appropriate protection and drainage, refer to AVM Aussie Membrane 520 "Min Thickness Table"
3. Contact AVM if no drain board or protection board is specified.
4. AVM's "Bottom Drain 12" may be accepted in lieu of the perforated drainage pipe (French Drain). Check local building codes for approval.
5. Exposed top of footing is Less than 3"
6. Inside corner (Wall-to-Footing) shown with Water Stop
7. Reinforce the Aussie Membrane 520 with AVM Mat 800 at all corners, metal transitions, penetrations, gaps, drains, etc.
8. Mortar cant strip and detail coat at the cold joint may be replaced with other cold joint details with prior approval from AVM.

AVM Industries, Inc.  
8245 Remmet Ave, Canoga Park, CA 91304

Quality Waterproofing Products

888.414.1041 818.888.0050  
www.avmindustries.com