

DETAIL #:
AVM-0520-1502-C

AVM SYSTEM 520

AUSSIE MEMBRANE 520

Planter Basic Detail
AVM AUSSIE MEMBRANE 520
Fluid Applied Waterproofing.

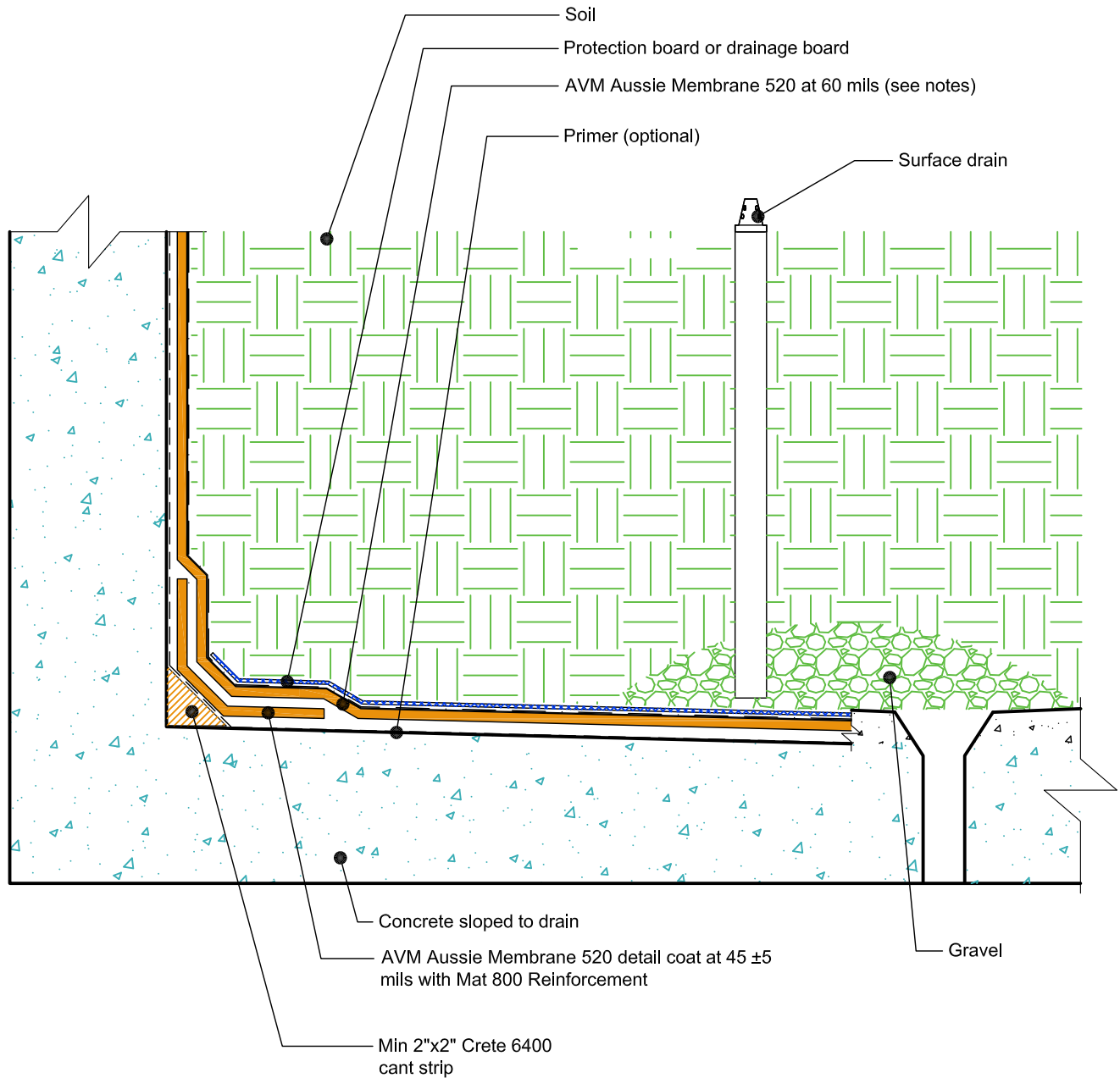

NOTES:

1. Aussie Membrane 520 is a Polyurethane liquid (Roller or Brush Applied) for Below-Grade, Between-Slab, Planters, Roof-Gardens and similar type Waterproofing.
2. For proper membrane thickness and appropriate protection and drainage, refer to AVM Aussie Membrane 520 "Min Thickness Table"
3. Contact AVM if no drain board or protection board is specified.
4. Planters must have sufficient slope, sufficient drains and proper drainage systems to effectively evacuate excessive water.
5. Reinforce the Aussie Membrane 520 with AVM Mat 800 at all corners, metal transitions, penetrations, gaps, drains, etc.
6. Mortar cant strip and detail coat at the cold joint may be replaced with other cold joint details with prior approval from AVM.

AVM Industries, Inc.
8245 Remmet Ave, Canoga Park, CA 91304

Quality Waterproofing Products

888.414.1041 818.888.0050
www.avmindustries.com