

DETAIL #:  
AVM-0520-3502-P

AVM SYSTEM 520

AUSSIE MEMBRANE 520

Pavers on Plywood Substrate over  
AVM AUSSIE MEMBRANE 520  
Fluid Applied Waterproofing.

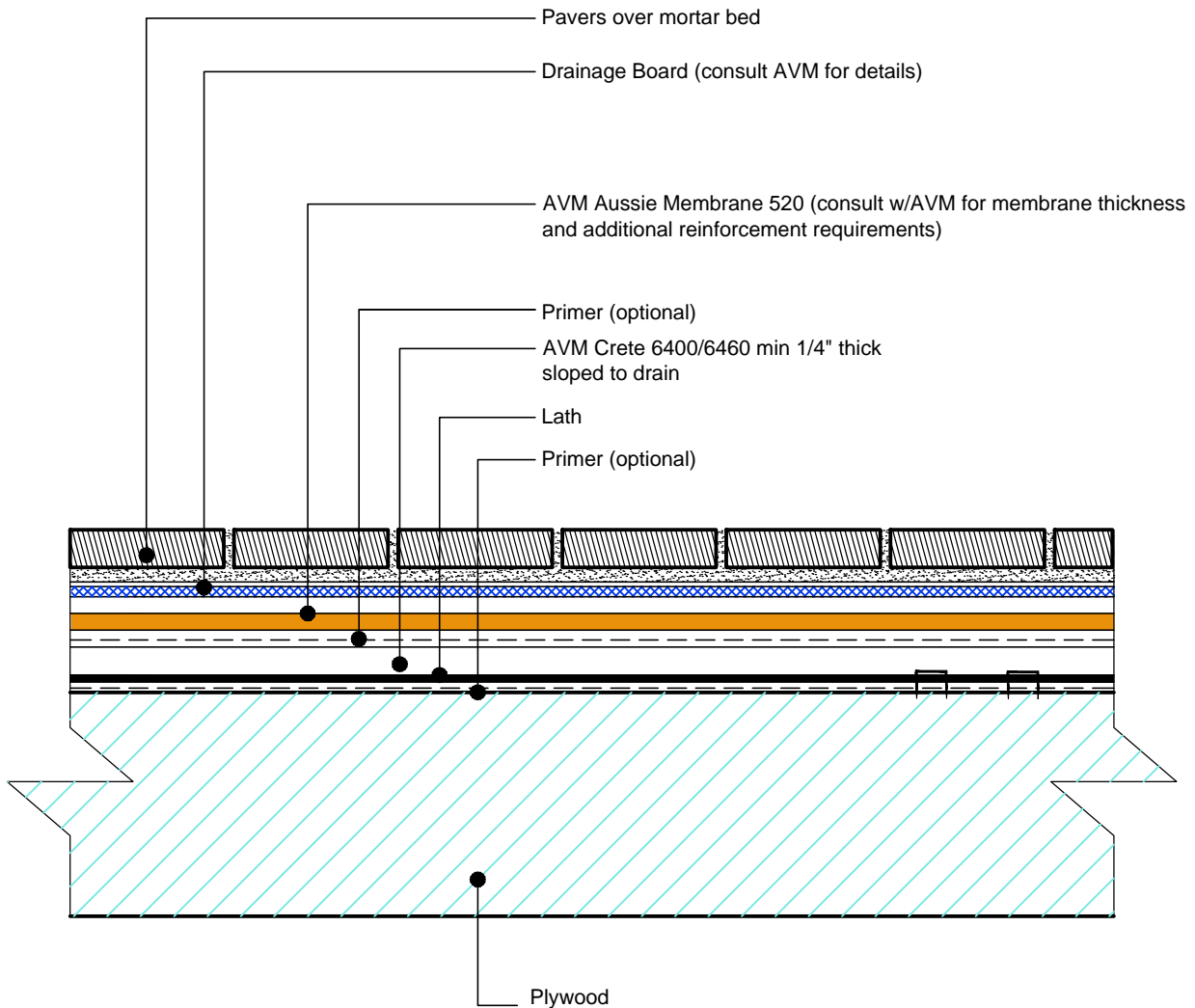

**NOTES:**

1. Aussie Membrane 520 is a Polyurethane liquid (Roller or Brush Applied) for Below-Grade, Between-Slab, Planters, Roof-Gardens and similar type Waterproofing.
2. For proper membrane thickness and appropriate protection and drainage, refer to AVM Aussie Membrane 520 "Min Thickness Table"
3. Contact AVM if no drain board or protection board is specified.
4. Crete 6400/6460. Refer to the Crete 6400 or Crete 6460 Technical Data Sheets or Installation Instructions for more info.

AVM Industries, Inc.  
8245 Remmet Ave, Canoga Park, CA 91304

Quality Waterproofing Products

888.414.1041 818.888.0050  
www.avmindustries.com

FILE NAME: 0520-3502-P-Pavers-On-Plywood-CS

Revision Date: 5/31/2016  
Protected by Copyright © AVM Industries, Inc.