

DETAIL #:
 AUSSIE-MATE-1502-C
 AVM SYSTEM 580/582/585
 AUSSIE MATE®

Planter Basic Detail
 AVM AUSSIE MATE®
 Bituminous Sheet Waterproofing.

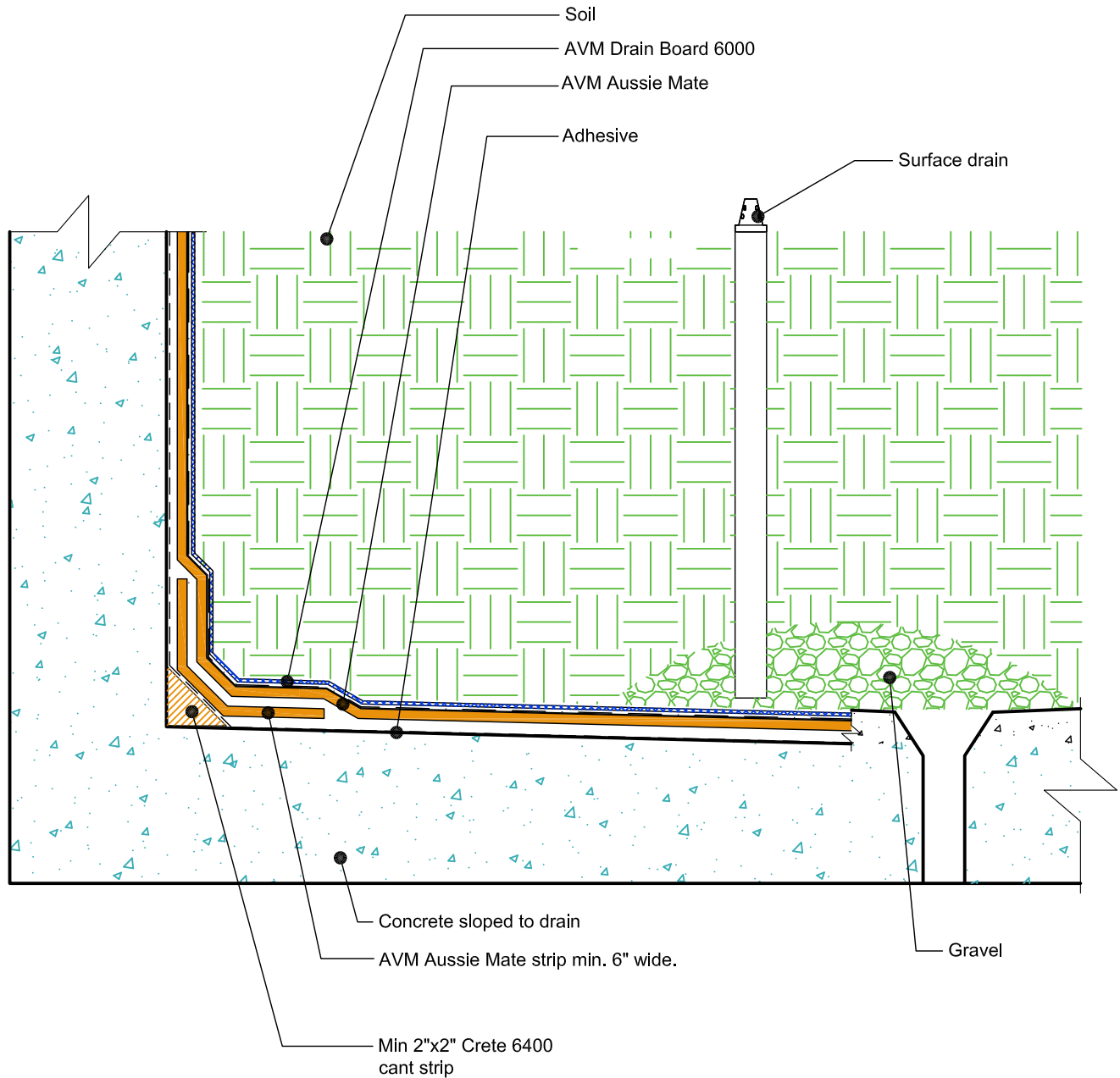

- NOTES:**
1. Aussie Mate® Membranes are heavy duty bituminous waterproofing sheet membranes for Below-Grade waterproofing applications. Aussie Mate® 580-AL and 582-AL are UV stable, 60-mil membranes with an aluminum protection layer. Aussie Mate® 585-CW is a cold weather membrane that can be installed at temperatures as low as 25°F (-4°C).
 2. For appropriate drainage/protection, use AVM Drain Board 6000.
 3. Contact AVM if no drain board or protection board is specified.
 4. Only AVM approved liquid adhesives or primers may be used. (water-based and solvent-based adhesives/primers are available)
 5. All Aussie Mate overlaps must be minimum 2.5".
 6. Planters must have sufficient slope, sufficient drains and proper drainage systems to effectively evacuate excessive water.
 7. Planters must be sloped to drains before membrane installation. (Min 1/4" per foot) Use AVM Crete 6400/6460 or other approved concrete.
 8. Crete 6400/6460. Refer to the Crete 6400 or Crete 6460 Tech Data Sheets or Installation Instructions for more information.

AVM Industries, Inc.
 8245 Remmet Ave, Canoga Park, CA 91304

Quality Waterproofing Products

888.414.1041 818.888.0050
 www.avmindustries.com

FILE NAME:
 AUSSIE-MATE-1502-C-Planter-Basic-Detail-CS

Revision Date: 2/19/2018
 Protected by Copyright @ AVM Industries, Inc.