

DETAIL # :
AVM-502-1502-C
Aussie Membrane 502

VIEW TYPE:
Cut Sheet

Planter Basic Detail

Aussie Membrane 502

Fluid Applied Waterproofing

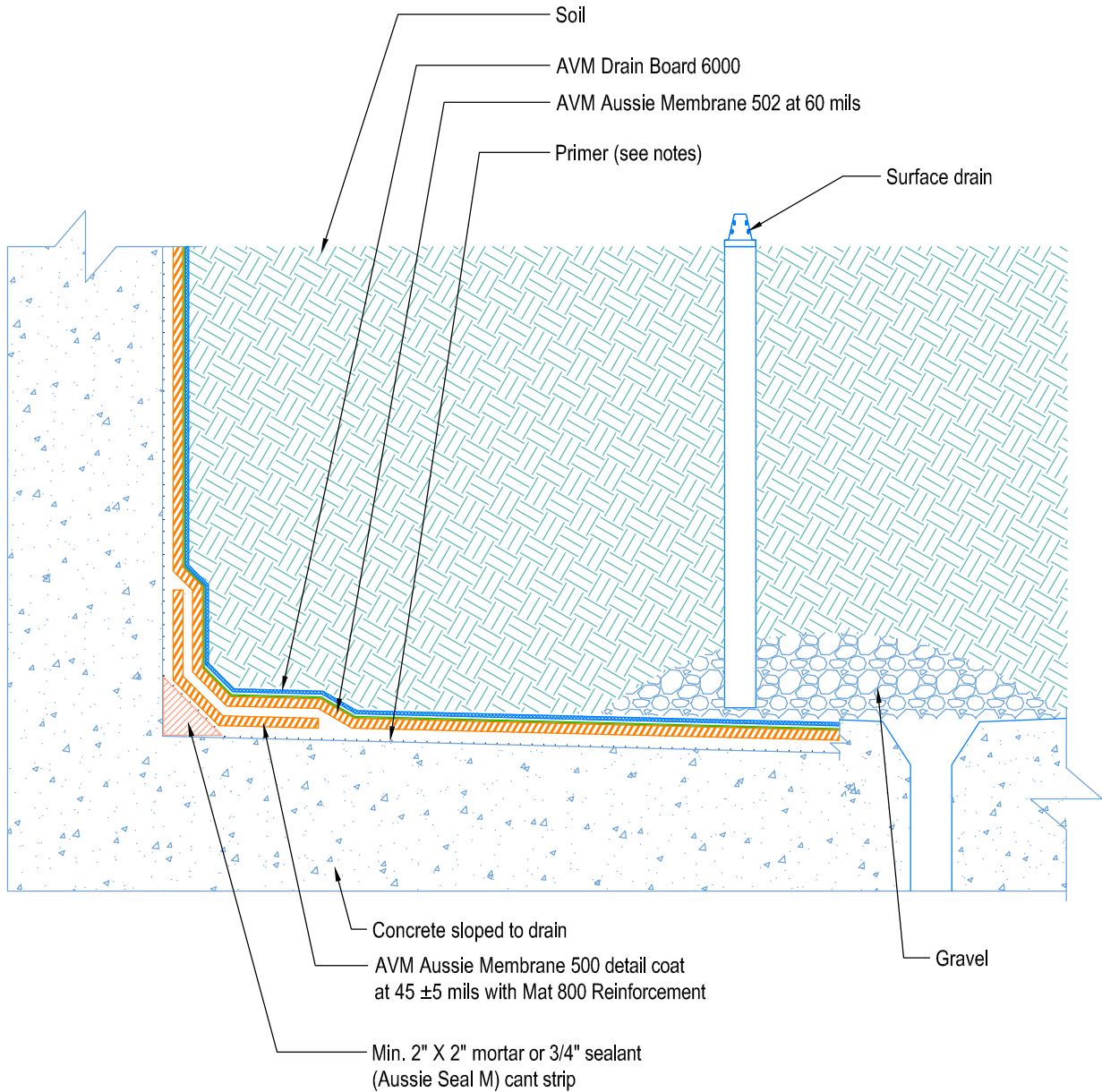

Notes:

1. Aussie Membrane 502 is a two-component, Water-Based Bitumen Membrane (Spray Applied) for Below-Grade, Lagging, Between-Slab, Planters, Roof-Gardens, Paver Systems and similar type Waterproofing.
2. In Non-Hydrostatic conditions: Min 60 Mills Dry Film Thickness (DFT). In Hydrostatic conditions: Min 90 Mills Dry Film Thickness (DFT)
3. Planters must have sufficient slope, sufficient drains and proper drainage systems to effectively evacuate excessive water.
4. All corners require fabric reinforced detail coat. All inside corners also require min 2"x2" mortar or 3/4" sealant (Aussie Seal M) cant prior to installing the detail coat.
5. Verify concrete wall absorbs water. If not, prime with AVM Adhesive 501. Otherwise, prime surfaces with Aussie Membrane 502 Resin.