

DETAIL # :	AVM-520-1502-C
AVM System 520 Aussie Membrane	
VIEW TYPE:	Cut Sheet

# Planter Basic Detail

## AVM System 520 Aussie Membrane

### Fluid Applied Waterproofing

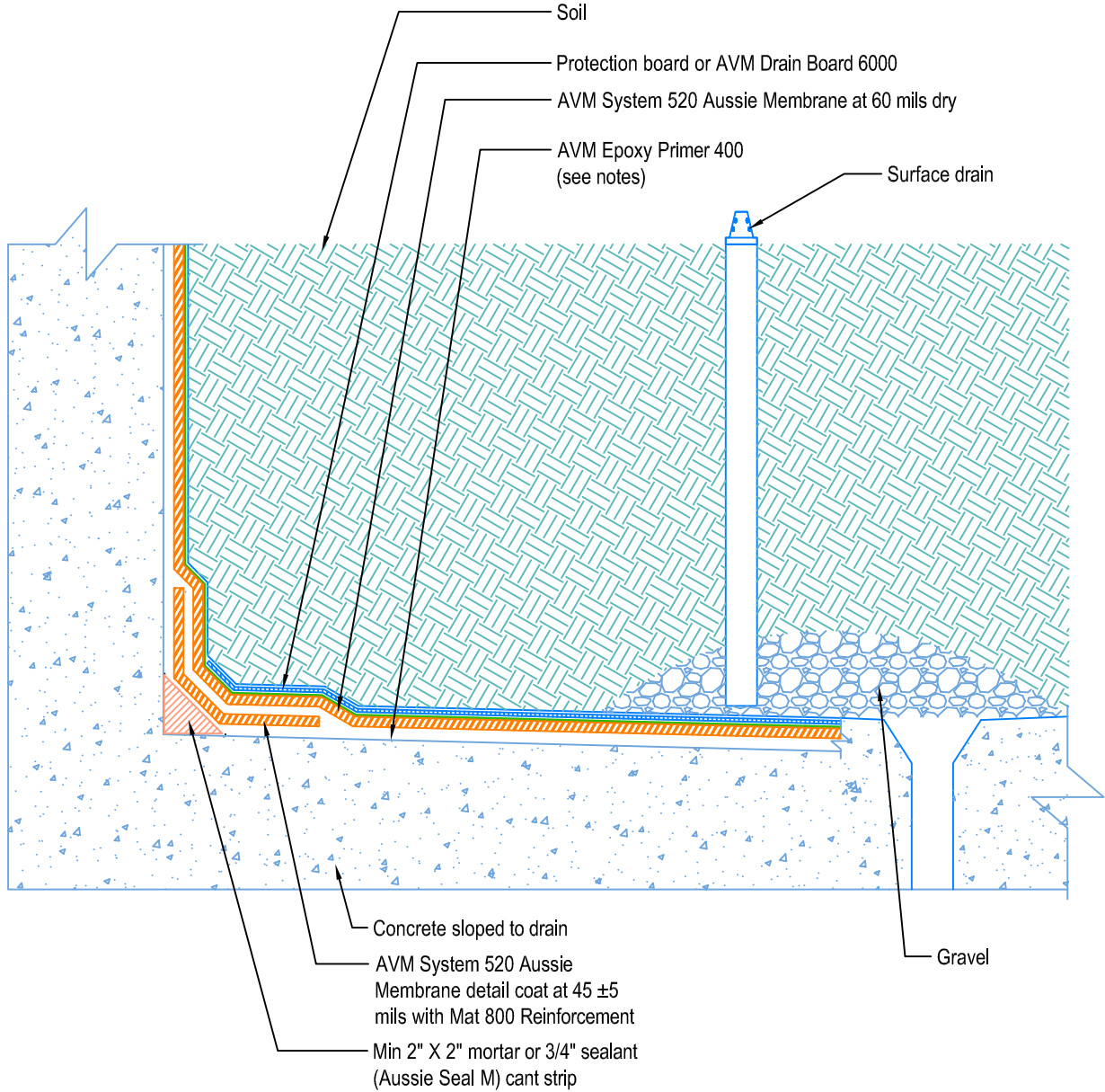

**Notes:**

1. Aussie Membrane 520 is a Polyurethane liquid (Roller or Brush Applied) for Below-Grade, Between-Slab, Planters, Roof-Gardens and similar type Waterproofing.
2. Epoxy primer may be required if proper adhesion is not achieved.
3. Some installations and warranties require thicker installations and/or fabric reinforcement. Consult AVM for details.
4. Contact AVM if no drain board or protection board is specified.
5. Planters must have sufficient slope, sufficient drains and proper drainage systems to effectively evacuate excessive water.
6. All corners require fabric reinforced detail coat. All inside corners also require min 2"x2" mortar or 3/4" sealant (Aussie Seal M) cant prior to installing the detail coat.
7. In planters, a root barrier may be required. Consult with Landscape Architect or contact AVM for details.