

DETAIL # :
 AVM-500-1502-C
 AVM System 500
 Aussie Membrane
 VIEW TYPE:
 Cut Sheet

Planter Basic Detail

AVM System 500 Aussie Membrane

Fluid Applied Waterproofing

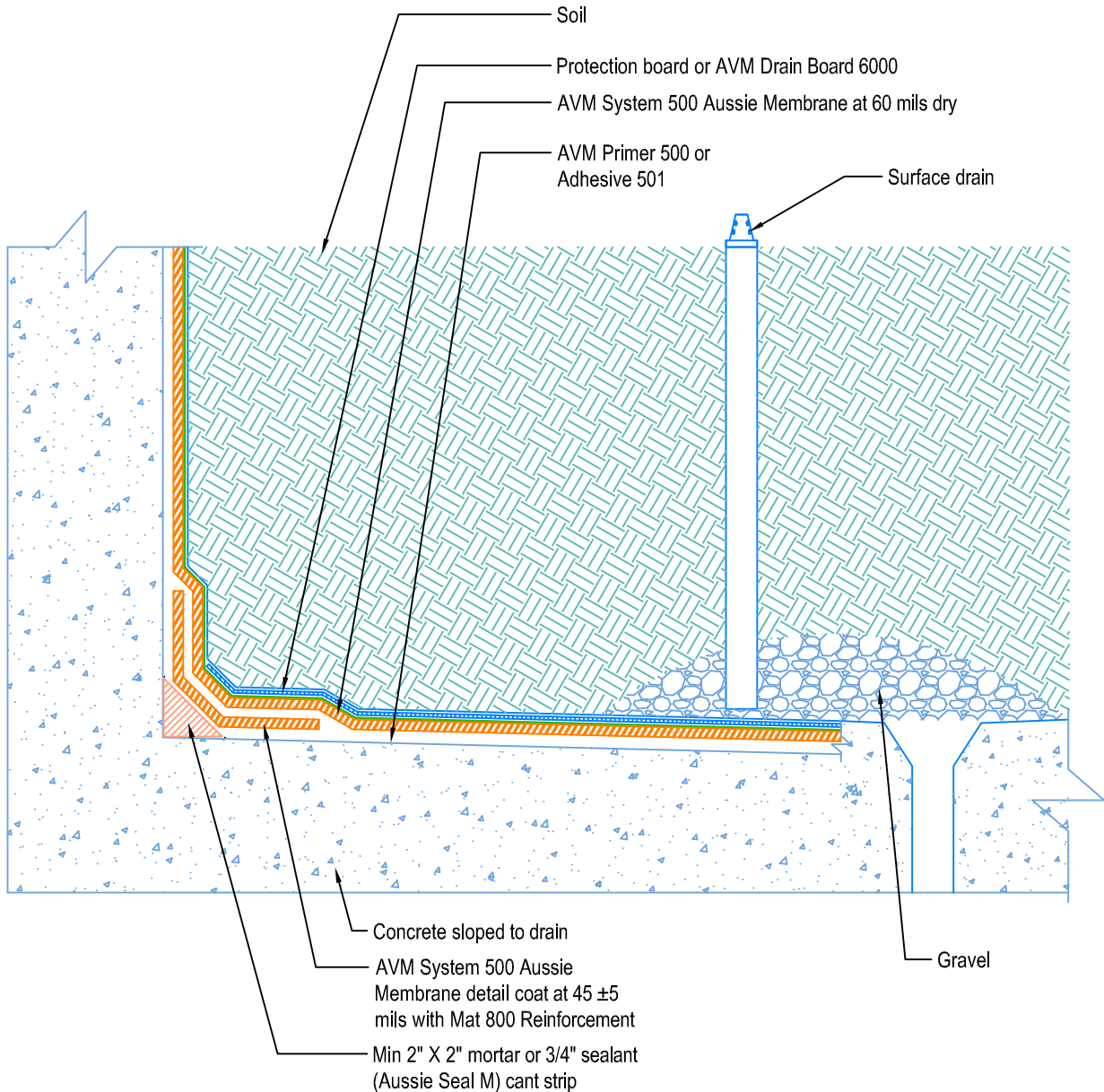

Notes:

1. Aussie Membrane 500 is a Water-Based Bitumen (Roller or Brush Applied) for Below-Grade, Between-Slab, Planters, Roof-Gardens and similar type Waterproofing.
2. Some installations and warranties require thicker installations and/or fabric reinforcement. Consult AVM for details.
3. Contact AVM if no drain board or protection board is specified.
4. Prime with AVM Adhesive 501 (solvent-based primer) or Primer 500 (water-based primer)
5. Planters must have sufficient slope, sufficient drains and proper drainage systems to effectively evacuate excessive water.
6. All corners require fabric reinforced detail coat. All inside corners also require min 2"x2" mortar or 3/4" sealant (Aussie Seal M) cant prior to installing the detail coat.
7. In planters, a root barrier may be required. Consult with Landscape Architect or contact AVM for details.