

DETAIL # :  
 AVM-500-2582-P  
 AVM System 500  
 Aussie Membrane  
 VIEW TYPE:  
 Cut Sheet

# Metal Straps at Plywood Joints Detail for Topping Slabs Waterproofing on Plywood Substrates

## AVM System 500 Aussie Membrane Fluid Applied Waterproofing

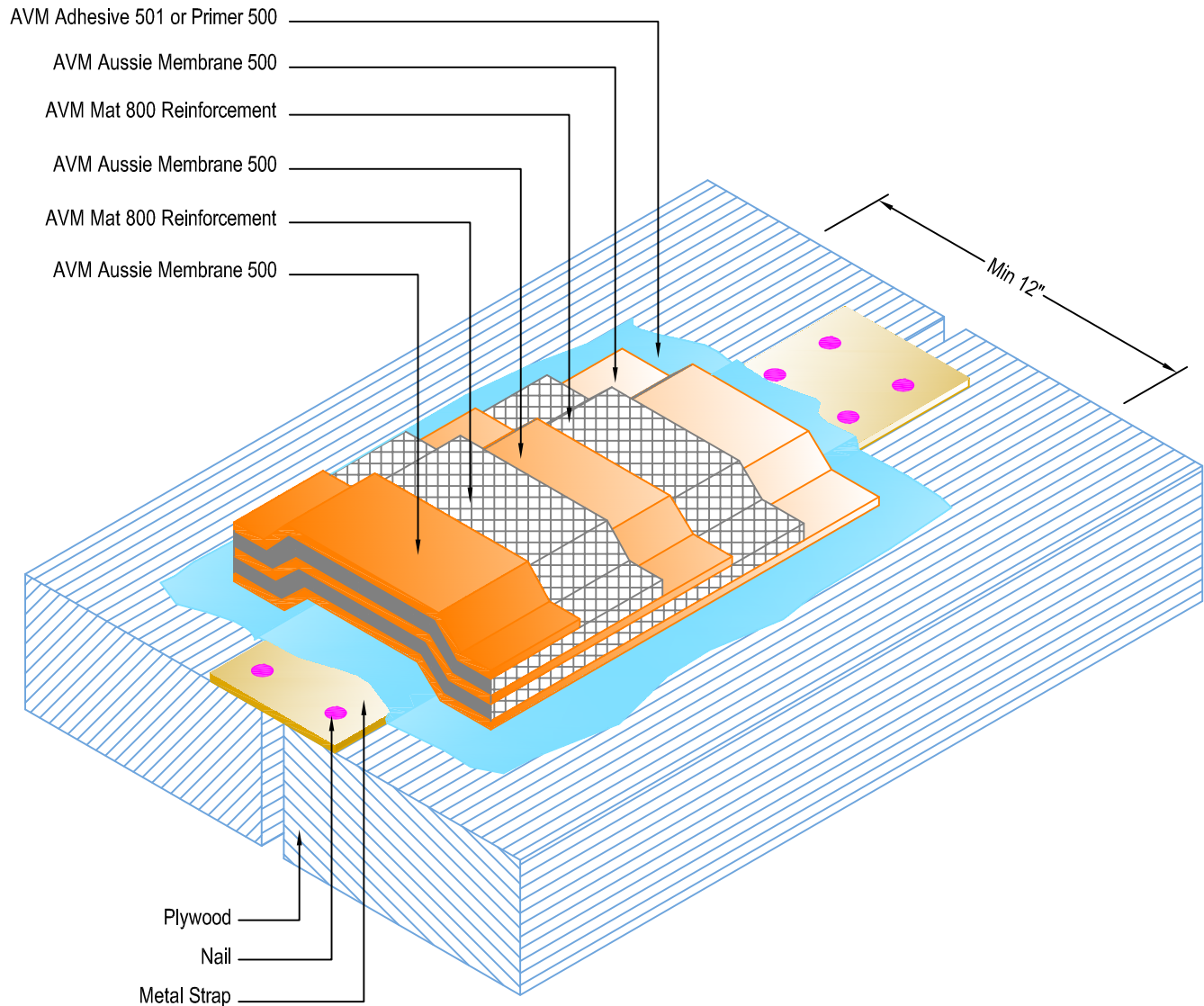

**Notes:**

1. This detail may not be applicable or needed if installing metal lath and AVM Crete 6400 over the plywood substrates before installing the Aussie Membrane. (See Detail # AVM-500-2502-P)
2. Aussie Membrane 500 is a Water-Based Bitumen (Roller or Brush Applied) for Below-Grade, Between-Slab, Planters, Roof-Gardens and similar type Waterproofing.
3. For proper membrane thickness and drainage / protection requirements, refer to other "Topping Slab on Plywood" Details.
4. Metal straps must be protected by 'Double Fabric'.
5. Make sure all nails are flush with the plywood surface or slightly sunken in below it. (Nails protruding above the plywood surface may puncture the membrane)
6. Remove/grind/repair as necessary any other protrusions, sharp edges, etc that may puncture or damage the membrane.
7. After priming the metal straps and surrounding plywood surfaces, apply a liberal coat of the Aussie Membrane before installing the first layer of fabric to ensure the strap edges and nail heads will not cut into or damage the fabric.

AVM Industries, Inc.  
 8245 Remmet Ave, Canoga Park, CA 91304

Quality Waterproofing Products

888.414.1041 818.888.0050  
 www.avmindustries.com