

DETAIL # :
 AVM-520-2580-P
 AVM System 520
 Aussie Membrane
 VIEW TYPE:
 Cut Sheet

Plywood Joint Detail for Topping Slabs Waterproofing on Plywood Substrates AVM System 520 Aussie Membrane Fluid Applied Waterproofing

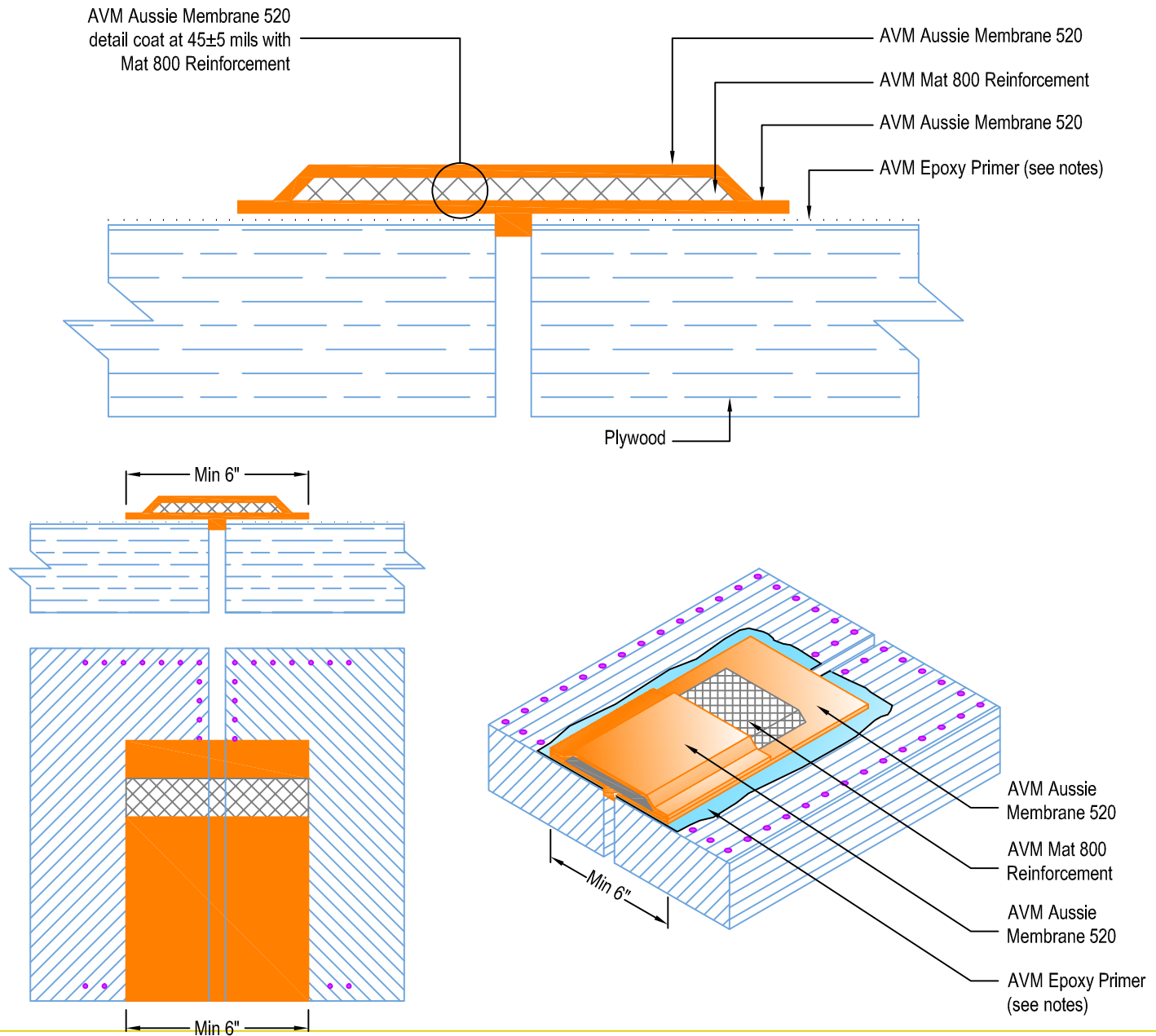

Notes:

1. This detail may not be applicable or needed if installing metal lath and AVM Crete 6400 over the plywood substrates before installing the Aussie Membrane. (See Detail # AVM-520-2502-P)
2. Aussie Membrane 520 is a Polyurethane liquid (Roller or Brush Applied) for Below-Grade, Between-Slab, Planters, Roof-Gardens and similar type Waterproofing.
3. Epoxy primer may be required if proper adhesion is not achieved.
4. Make sure all nails are flush with the plywood surface or slightly sunken in below it. (Nails protruding above the plywood surface may puncture the membrane)
5. Remove/grind/repair as necessary any other protrusions, sharp edges, etc that may puncture or damage the membrane.
6. Reinforce the Aussie Membrane with AVM Mat 800 as shown at all plywood joints, flashings, penetrations, etc.
7. If extra protection is needed, use double reinforcement. (two layers of Mat 800 reinforcing fabric)