

DETAIL #:  
AVM-0580-AL-1502-C

AUSSIE MATE® 580-AL

Planter Basic Detail  
AVM AUSSIE MATE® 580-AL  
Bituminous Sheet Waterproofing.

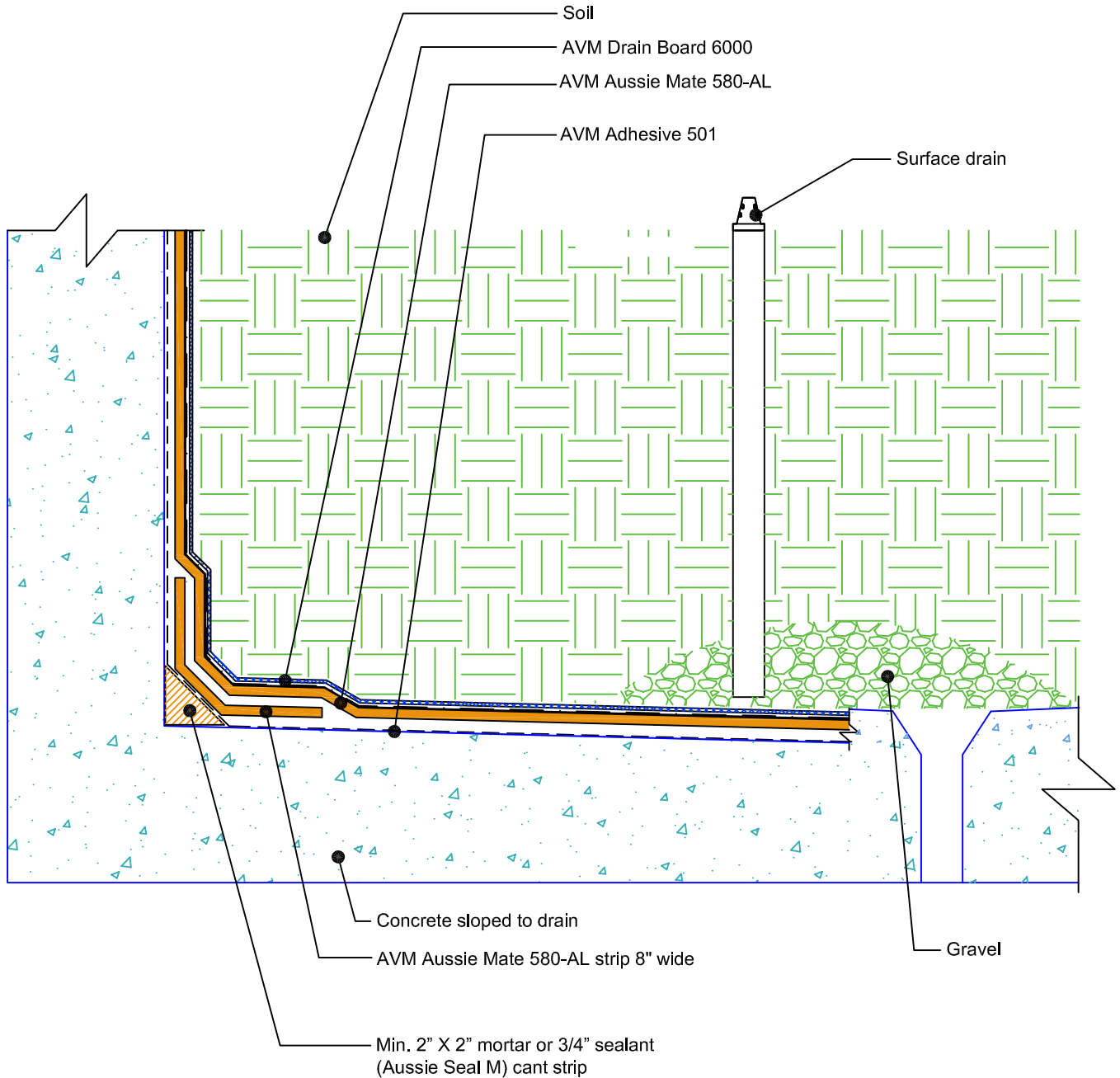

NOTES:

1. Aussie Mate 580-AL is an LARR approved Waterproofing membrane and Methane Barrier.
2. Aussie Mate 580-AL is a UV stable, 60-mil heavy duty bituminous sheet membrane with aluminum protection layer for Below-Grade waterproofing applications. Aussie Mate 580-AL may also be used as a methane and/or vapor barrier under horizontal slabs on grade.
3. For applications from 25°F- 50°F, contact AVM for cold weather installation instructions.
4. Ensure drains are properly protected to ensure proper drainage of water.
5. For appropriate drainage/protection, use AVM Drain Board 6000.
6. Contact AVM if no drain board or protection board is specified.
7. All Aussie Membrane 580-AL overlaps must be minimum 2."
8. Planters must have sufficient slope, sufficient drains and proper drainage systems to effectively evacuate excessive water.
9. Planters must be sloped to drains before membrane installation. (Min 1/4" per foot) Use AVM Crete 6400/6460 or other approved concrete.
10. Crete 6400/6460. Refer to the Crete 6400 or Crete 6460 Tech Data Sheets or Installation Instructions for more information.

AVM Industries, Inc.  
8245 Remmet Ave, Canoga Park, CA 91304

Quality Waterproofing Products

888.414.1041 818.888.0050  
www.avmindustries.com