



AVM Aussie Clay

Aussie Clay is a heavy-duty Bentonite Composite Sheet Waterproofing Membrane

Sections - 071000/071700/071713/071716

Product Name

AVM AUSSIE CLAY (Internal reference: AVM System 590)

Manufactured by

AVM Industries, Inc.
8245 Remmet Ave, Canoga Park, CA 91304
888.414.1041 818.888.0050
www.avmindustries.com

Product Description

The AVM Aussie Clay is a heavy-duty high strength Bentonite Composite Sheet Waterproofing Membrane consisting of needle punched woven and non-woven geotextile fabrics encapsulating a thick layer (1 lb/sq.ft. / 4.8 kg/M²) of active sodium bentonite between them.

Aussie Clay works by forming a low permeability membrane once it comes in contact with water. Once wetted, the sodium bentonite swells (up to 15 times its size when unconfined) to form a strong continuous membrane. As Aussie Clay swells, it's also designed to self-seal and expand towards the concrete to fill-in small cracks and voids, as well as reduce the potential of lateral water migration. Aussie Clay forms a mechanical bond to the concrete in a pre-applied waterproofing application.

The hydration of Aussie Clay can be restricted if ground water is contaminated with either salt, Chemicals or other foreign substances. (As determined by the site water analysis). If ground water contains strong acids, alkalis, or other contaminants, or is of a conductivity of 2,500 mhos/cm or greater, Aussie Clay SW or Aussie Clay SW-PL must be used. Please contact your local rep for details.

Where to Use

Retaining Walls, Basements, Under-Slabs, Mud-Slabs

AVM Aussie Clay is designed for below-grade vertical and horizontal structural foundation surfaces. Aussie Clay may be applied vertically to permanent formwork such as lagging or other property line construction or to existing back-filled structural walls. Aussie Clay may also be applied horizontally either to smoothly prepared concrete substrates and/or compacted earth or crushed stone substrates. Aussie Clay may also be used in conjunction with the AVM Aussie Skin membrane as part of a "Dual Membrane" Assembly.

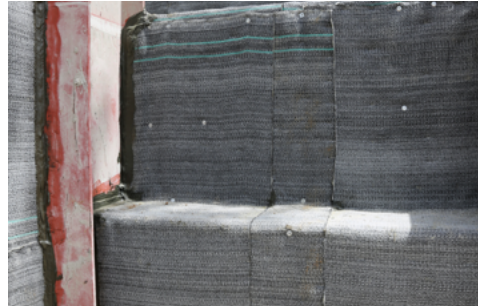

Application Method

Pre-Applied, loosely laid.

Warranty

AVM Industries will warrant the installed membrane for a period of five (5) years. Extended warranties are available. For complete warranty details, contact AVM Industries or consult with your applicator. Shot-Crete to conform to ACI 506 Standards.

Delivery, Storage, and Handling

- Delivery of all Aussie Clay system components to the job site must be in their original sealed packaging, with manufacturer's name and label intact.
- Handle and store containers in accordance with printed instructions.
- Store in a dry cool space at temperatures between 50°F and 90°F. (Aussie Clay Sealant must be stored at temperatures between 50°F and 75°F) Do not store materials in direct sunlight or where they may be damaged by water or rain.
- Failure to comply with the recommended storage conditions may result in premature deterioration of the product. For specific storage advice, please contact AVM Industries and/or its representatives.
- Keep all materials out of the reach of children.
- If irritation occurs during use, liberally flush affected areas with water. If irritation continues, see a physician immediately.

Project Conditions

- Aussie Clay should be installed over a sound substrate that is free from sharp protrusions or anything else that might damage or prevent the proper installation or performance of the membrane.
- Do not install Aussie Clay over cardboard void forms.
- Do not use stay-in-place concrete forms. Use removable forming products only.
- Aussie Clay should not be installed in standing water or over ice.
- Protect adjacent surfaces which could be damaged during the application procedure.

- This system must not be used to cover Expansion Joints.

System Application

Read the Aussie Clay Training Manual/ Installation Instructions Prior to Installation. Application instructions vary based on application surfaces, job conditions and other factors.

Quality Control

- Visually inspect all coated surfaces to ensure a full and proper application, especially at seams, corners, drainage footings, penetrations and other hard-to-reach areas.
- All unsatisfactory areas shall be repaired prior to final acceptance.

Protection of Installed Work

- The membrane shall be protected until backfilled or concrete is properly poured over it.
- Refer to Aussie Clay Training Manual/ Installation Instructions for complete protection requirements.

Availability and Cost

Contact AVM Industries or your approved applicator for pricing and availability.

Technical Services

Technical services are available by contacting our offices at: **888.414.1041** or **818.888.0050** or visit **www.avmindustries.com**

System Specifications

See next page.

PATENT PENDING: Some features of our product or assembly are protected under patent laws by one or more pending US patent(s).

Technical Data

Property	Test Method	Results	Unit
Swell Index	ASTM D5890	≥24	ml/2g
Fluid Loss	ASTM D5891	≤18	ml/2g
Bentonite Mass Per Unit Area	ASTM D5993	1.0 (4.8)	lb/sqft (kg/sqm)
Hydrostatic Resistance	ASTM D5385M	231 (70)	ft (m)
Permeability	ASTM D5084	1 x 10 ⁻¹¹	m/s max
Tensile Strength	ASTM D6768	8.0/8.0	kN/m min
Puncture Resistance	ASTM D6241	337 lbs (1.5)	lbs (kN)
Peel Adhesion to Concrete	ASTM D903M	15 (2.6)	lbs/in (kN/m)
Low Temperature Flexibility	ASTM D1970	Unaffected	-25°F (-32°C)
Hydrostatic Pressure Resistance	ASTM D751	119 (36)	ft (m)
Puncture Resistance	ASTM E154	244	lbf
Peel Adhesion to Concrete (Updated)	ASTM D903	16	lbf/in
Tension & Elongation (MD/CMD)	ASTM D2523	271/200	%
Resistance to Soil Decay (Weight Loss/Hydraulic Conductivity)	ASTM E154/D5084	≤10 (Pass)	%

Item/Component	Packaging	Approximate Shipping Weights	Qty/Pallet	Weight/Pallet	Qty/Truck	VOC
AUSSIE CLAY	3.77'x16.4' Roll (61.9 sq.ft.)	73.4 lbs. (33.3 kg) / Roll	35 Rolls/Pallet	2615 Lbs (1186 kg)	16 Pallets *	N/A

For a complete list of details in CAD or PDF, please visit our website at www.avmindustries.com.

AVM Industries, Inc.
8245 Remmet Ave, Canoga Park, CA 91304
888.414.1041 818.888.0050

Quality Waterproofing Products



www.avmindustries.com