

DETAIL #:
0590-0001B
AVM System 590
Aussie Clay

Typical Under Slab Assembly and Overlap Spacing - Dual System

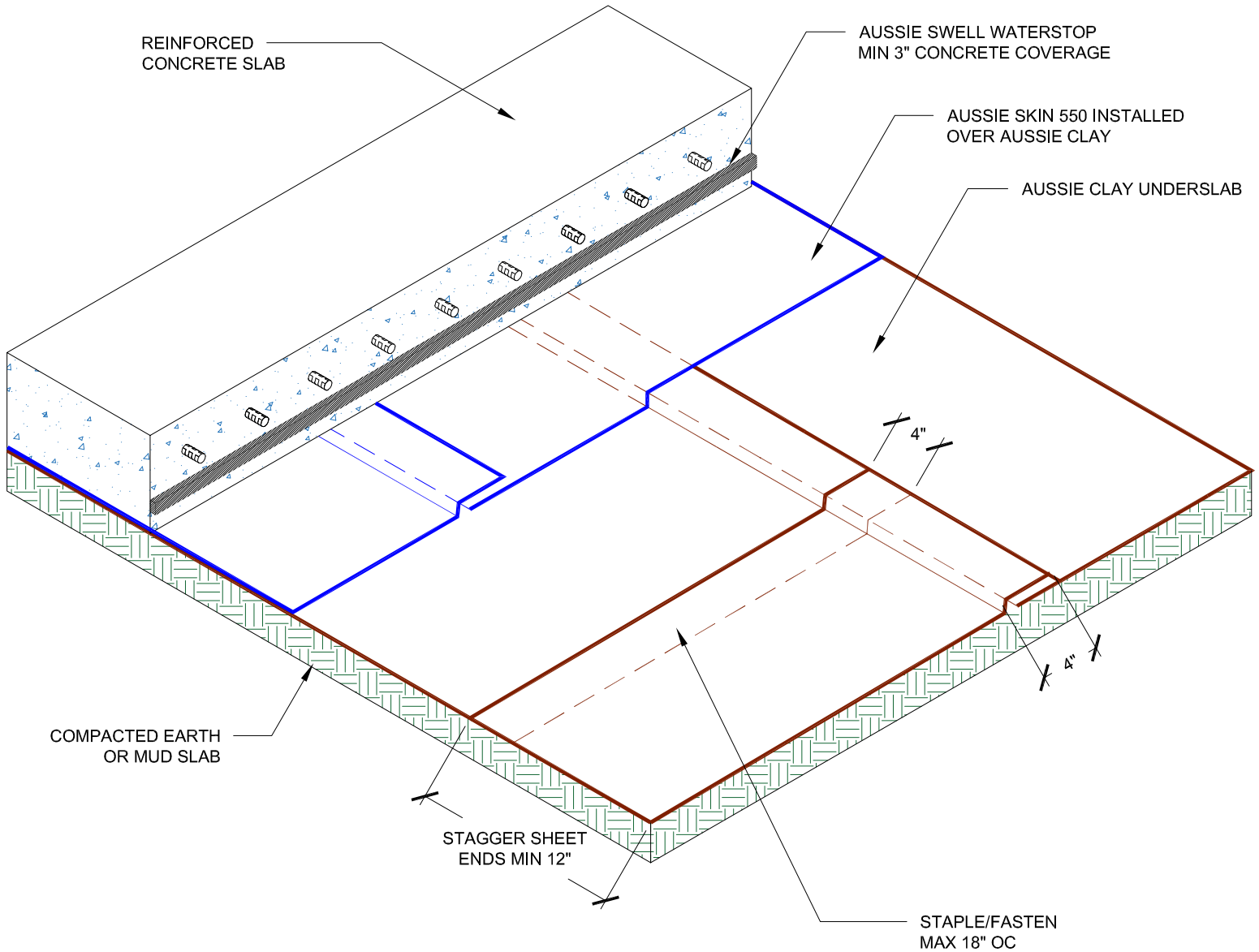

Notes:

1. Aussie Clay & Aussie Clay PL are bentonite sheet membranes for waterproofing below-grade vertical and horizontal surfaces, including blindside and backfilled applications. Aussie Clay can be used with shotcrete or cast in place concrete in hydrostatic or non-hydrostatic conditions.
2. Install Aussie Clay and Aussie Clay PL with gray geotextile facing installer
3. Overlap sheet edges 4" and stagger seams min 12"