

DETAIL #:  
0590-0207

AVM System 590

Aussie Clay

# Sleeved Pipe Penetration Backfilled Wall Non-Hydrostatic

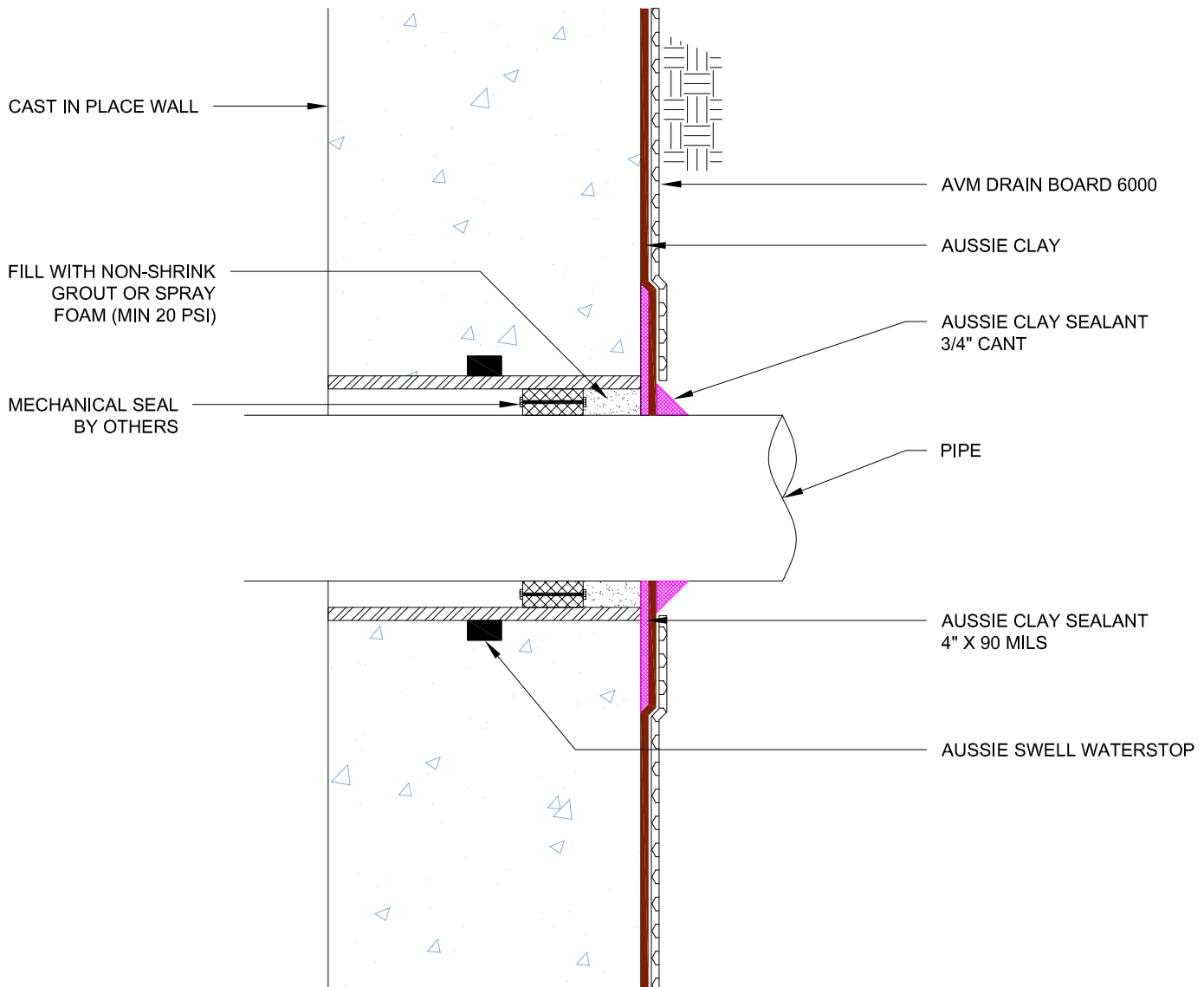

## Notes:

1. Aussie Clay & Aussie Clay PL are bentonite sheet membranes for waterproofing below-grade vertical and horizontal surfaces, including blind side and backfilled applications. Aussie Clay can be used with shotcrete or cast in place concrete in hydrostatic or non-hydrostatic conditions.
2. Install Aussie Clay with gray geotextile against concrete. Install Aussie Clay PL with poly liner facing installer
3. Fasten Aussie Clay with washer-head fasteners placed maximum 24" on center
4. Overlap sheet edges 4" and stagger seams min 12"
5. All gaps around penetrations must be filled with solid material (grout or expanding spray foam)