

DETAIL #:
0550G-1240
AVM System 550G

Typical Lagging Wall Metal Sheet Pile with Plywood Single System (Non-Hydrostatic)

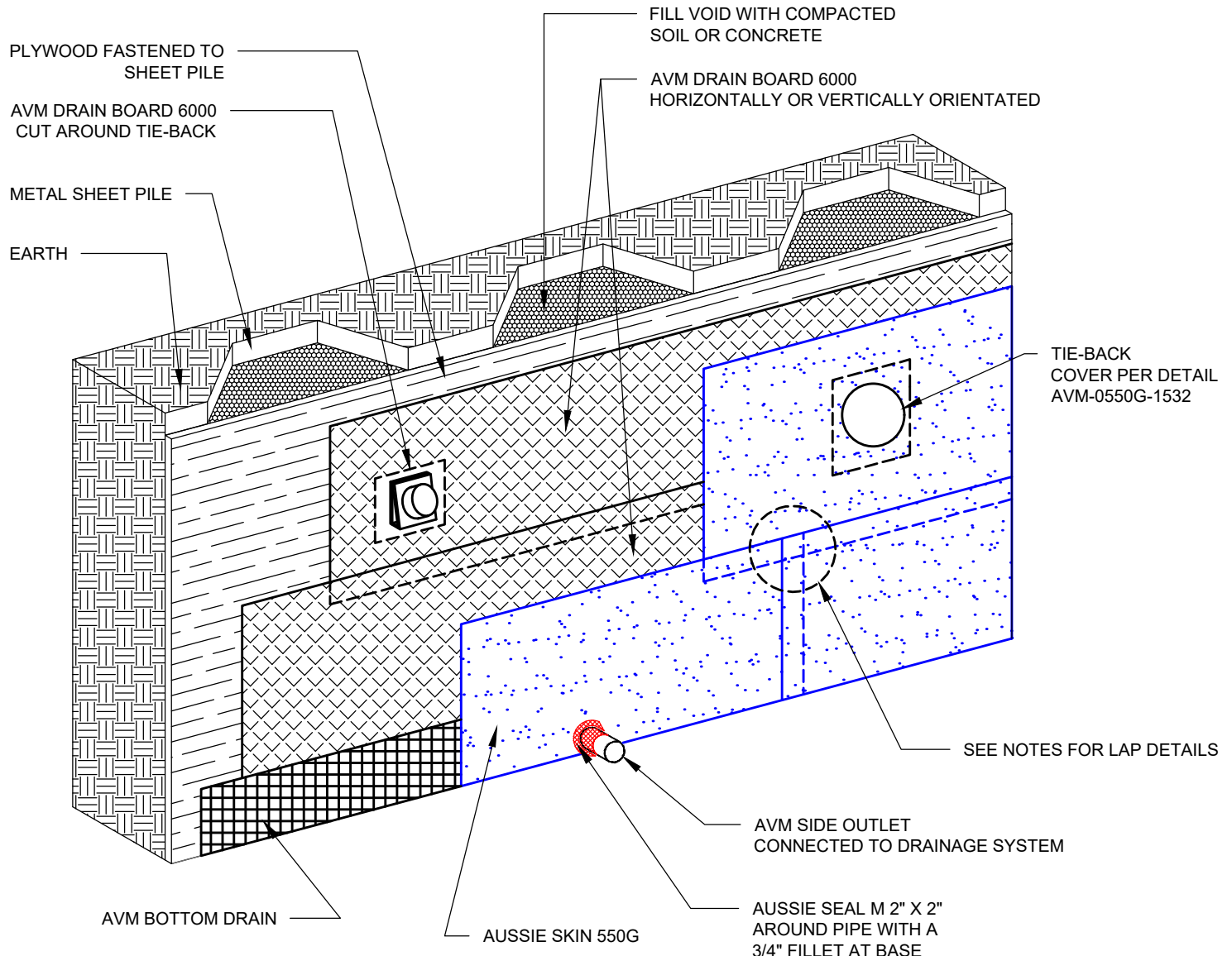

Notes:

1. Aussie Skin 550G is a Heavy, Duty, Easy to Install, Puncture Resistant Sheet Waterproofing Membrane with added technologies creating excellent adhesion between the membrane and wet Concrete or Shot-Crete.
2. Contact AVM if no drain board or protection board is specified.
3. Remove/grind/repair as necessary any other protrusions, sharp edges, etc that may puncture or damage the membrane.
4. When using nails to hang the membrane, make sure all nails are flush with the membrane's surface or slightly sunken in below it. (Nails protruding above the membrane's surface may puncture the membrane)
5. All nails, screws etc used to hang the Aussie Skin above the water table must be non-rusting and sealed with Aussie Seal M.
6. Not approved for shotcrete below the water table
7. See details AVM-550G-6000, AVM-550G-60002, AVM-550G-6004, and AVM-550G-6010 for Aussie Skin Lap Details