

DETAIL #:
 0520-0002
 System:
 Aussie Mambrane 520

Backfilled Wall with Vapor Barrier Under Slab

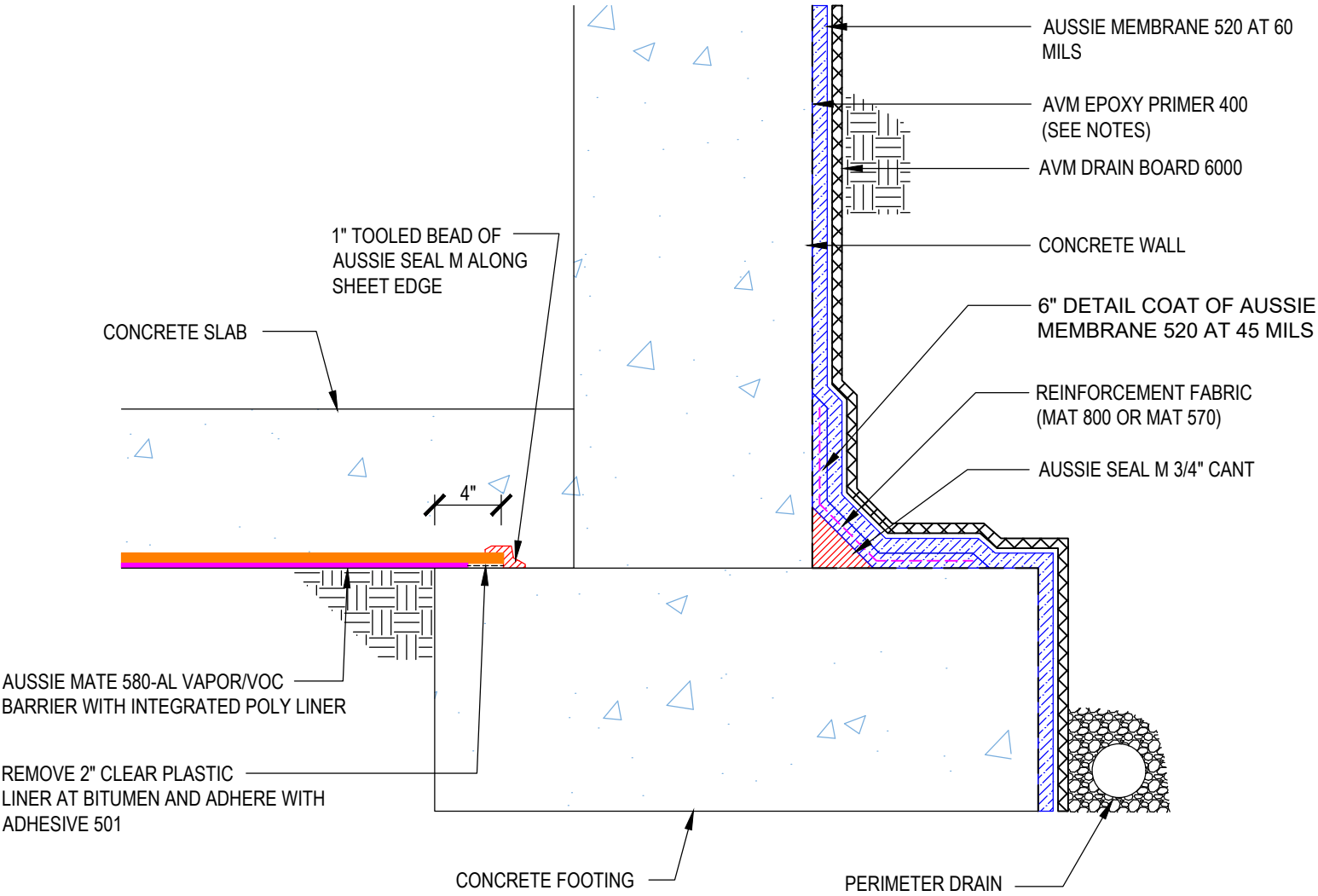

AUSSIE MEMBRANE 520



Notes:

1. Aussie Membrane 520 is a Polyurethane liquid (Roller or Brush Applied) for Below-Grade, Between-Slab, Planters, Roof-Gardens and similar type Waterproofing.
2. Epoxy primer may be required if proper adhesion is not achieved - see installation instructions for further information
3. Contact AVM if no drain board or protection board is specified