

DETAIL #:  
0520-1109  
System:  
Aussie Membrane 520

# Split Slab Edge Termination

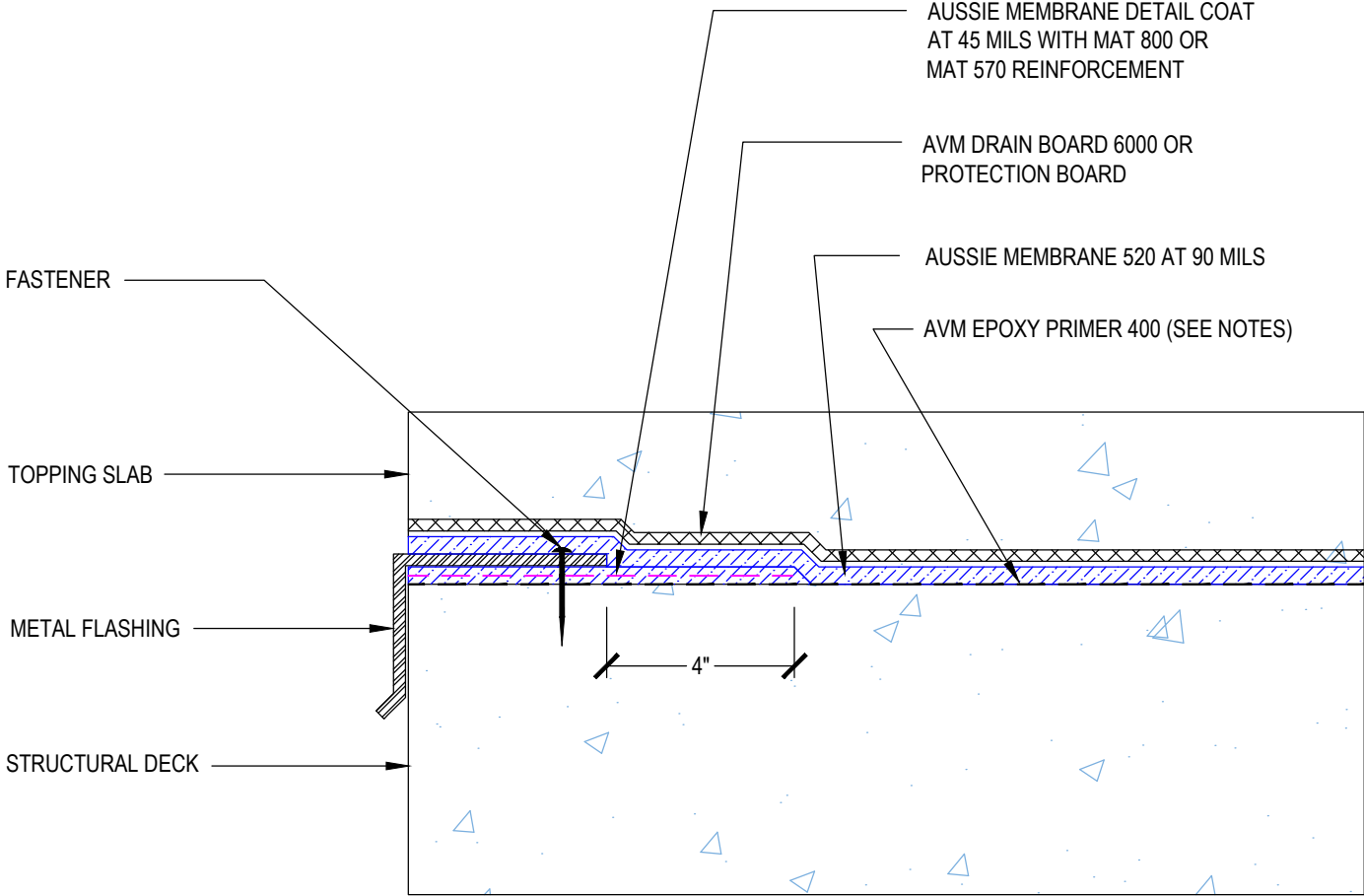

**AUSSIE MEMBRANE 520**  
**90 Mil Unreinforced System**



**Notes:**

- 1. Aussie Membrane 520 is a Polyurethane liquid (Roller or Brush Applied) for Below-Grade, Between-Slab, Planters, Roof-Gardens and similar type Waterproofing.
- 2. Epoxy primer may be required if proper adhesion is not achieved - see installation instructions for further information
- 3. Contact AVM if no drain board or protection board is specified