

DETAIL #:
 0550G_0560G-2808
 AVM System 550G/560G

Slab Tie Penetration

Aussie Skin 550G/560G

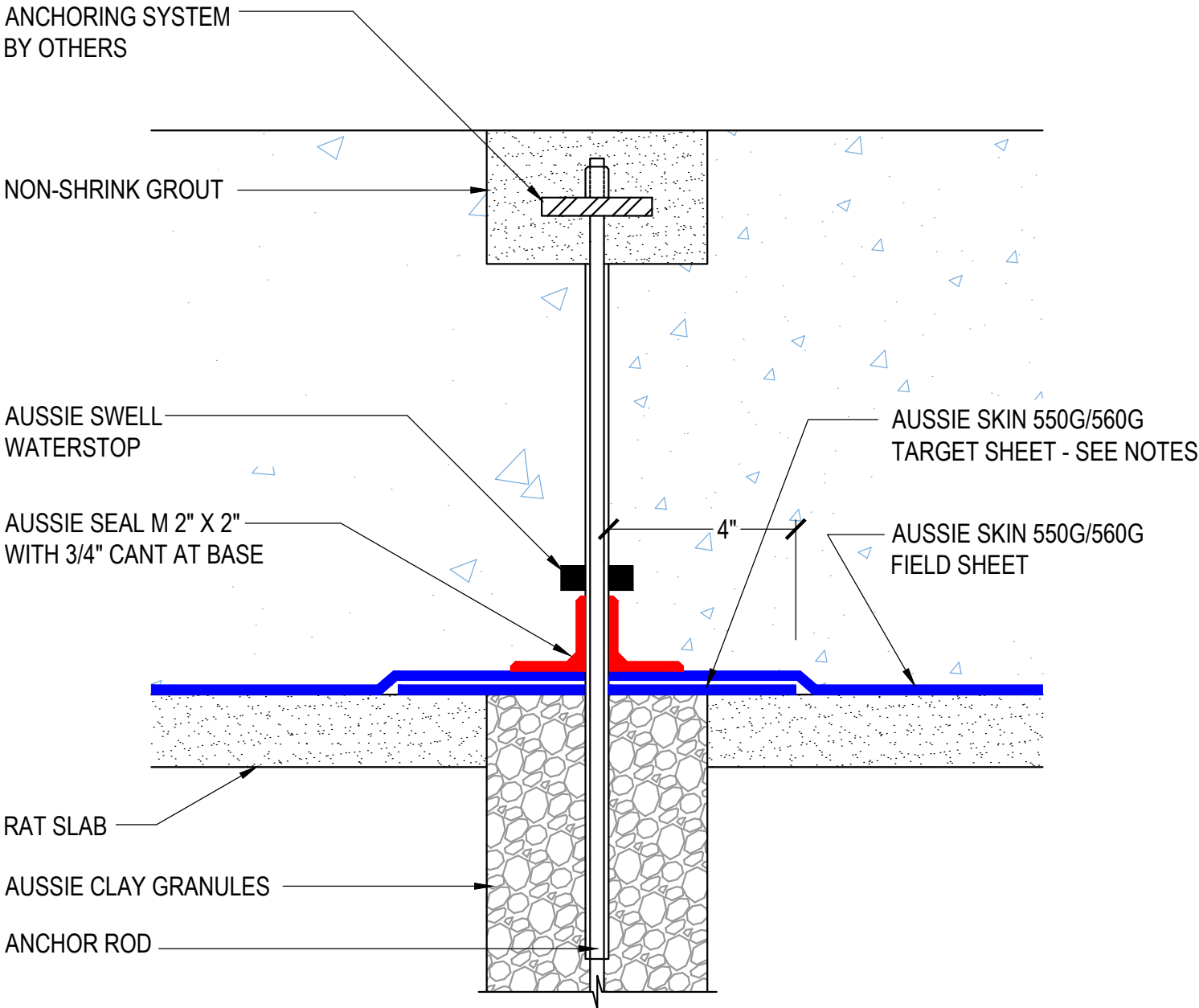

Notes:

1. Aussie Skin 550G and 560G are Heavy Duty, Easy to Install, Puncture Resistant Sheet Waterproofing Membranes with added technologies creating excellent adhesion between the membrane and wet Concrete or Shotcrete. Aussie Skin 560G is an approved methane/VOC barrier.
2. Target sheet is required if gap between field sheet and rod is >2"