

DETAIL #:  
**0100-FEC-752-P-CS**  
 AVM System 100  
 Forevercoat

# Drain Assembly Over Plywood Substrate AVM System 100 Forevercoat

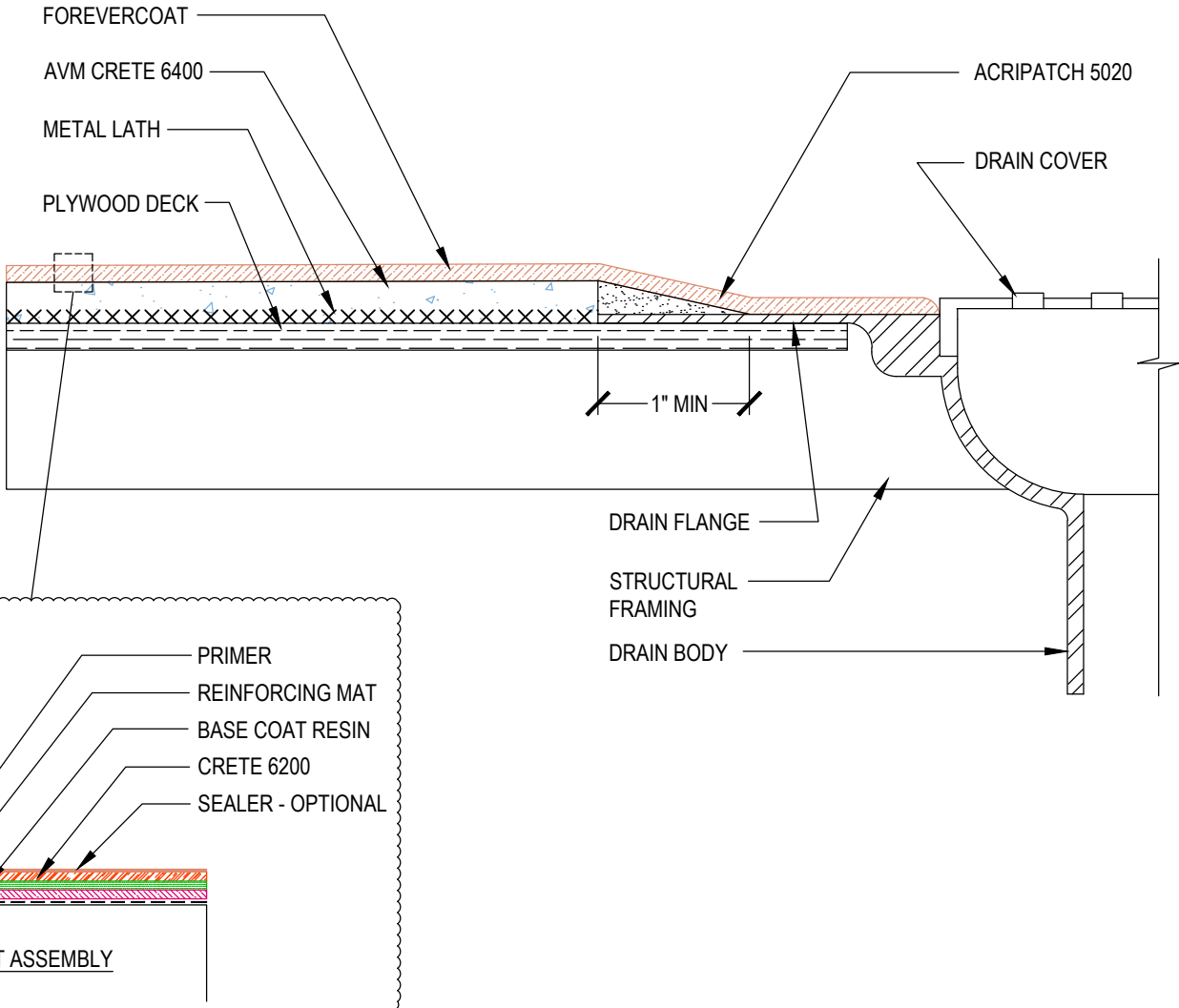

**Notes:**

1. Stop AVM Crete 6400 at least 2" before drain opening leaving a minimum of 2" exposed flange
2. Install Acripatch 5020 to transition from Crete 6400 to flange leaving a minimum 1" of flange exposed for direct membrane bonding
2. Ensure drain sits low enough and that there is sufficient slope to properly drain the water