

Rebar Supports and Waterproofing

AVM Aussie Skin Systems are designed to be installed over prepared substrates both horizontally underslab and vertically onto walls prior to concrete placement so that when concrete is placed, the system will form a permanent bond during the curing of the concrete. Prior to concrete placement, steel reinforcement is placed over the system by being held up by rebar supports. These rebar supports are placed directly onto the system typically every 2 ft or so on center. These locations of the rebar supports are points of weight bearing loads so it is important that the correct types of rebar supports are chosen so the distribution of that load of the reinforcement will not risk damaging or puncturing the system.

There are several different types of rebar supports: brick supports (such as dobies, blocks, or pavers), individual chairs, or continuous chairs known as beam bolsters. Sometimes the steel chairs have plastic caps or tips and the point of contact with the system.

REBAR SUPPORTS – ACCEPTABLE vs UNACCEPTABLE

Any rebar support that has a flat surface and distributes the weight of the rebar evenly so that there is not risk of the chair or support puncturing the system when fully loaded with the weight of the reinforcement or other loads is acceptable.

Dobies/Pavers are acceptable and preferred for both horizontal and vertical applications. These dobies will provide that flat surface for distributing the weight evenly that eliminates the risk of punctures.

Beam Bolsters without pointed ends are acceptable for both horizontal and vertical applications as well.

Steel Chairs or Beam Bolsters with pointed ends that contain a point load of less than 1" in diameter is unacceptable. These point loads stress the system with the weight of the reinforcement in small areas that can result in puncturing or damaging the system.

CONCLUSION

It is vital that the correct supports are specified to be used over AVM Aussie Skin systems to prevent damage to the membrane. Dobies and other brick supports are always preferred as they evenly distribute weight of the reinforcement without risking point loads that can result in punctures.



BRICK SUPPORT

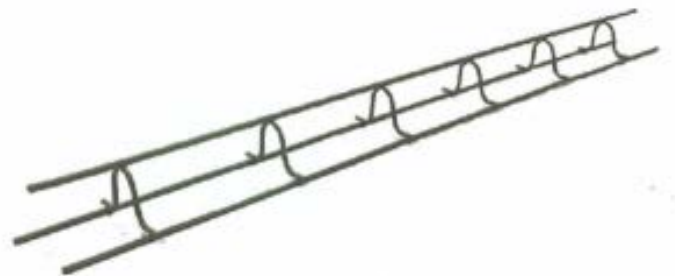

BEAM BOLSTER WITHOUT POINTED END



REBAR CHAIRS WITH POINTED ENDS

For additional or specific questions regarding Aussie Mate 580-AL cold weather installation, please consult your local AVM Sales Representative or the Technical Services department at: **888.414.1041** or **818.888.0050**.