

DETAIL #:  
 0520-0002  
 System:  
 Aussie Mambrane 520

# Backfilled Wall with Vapor Barrier Under Slab

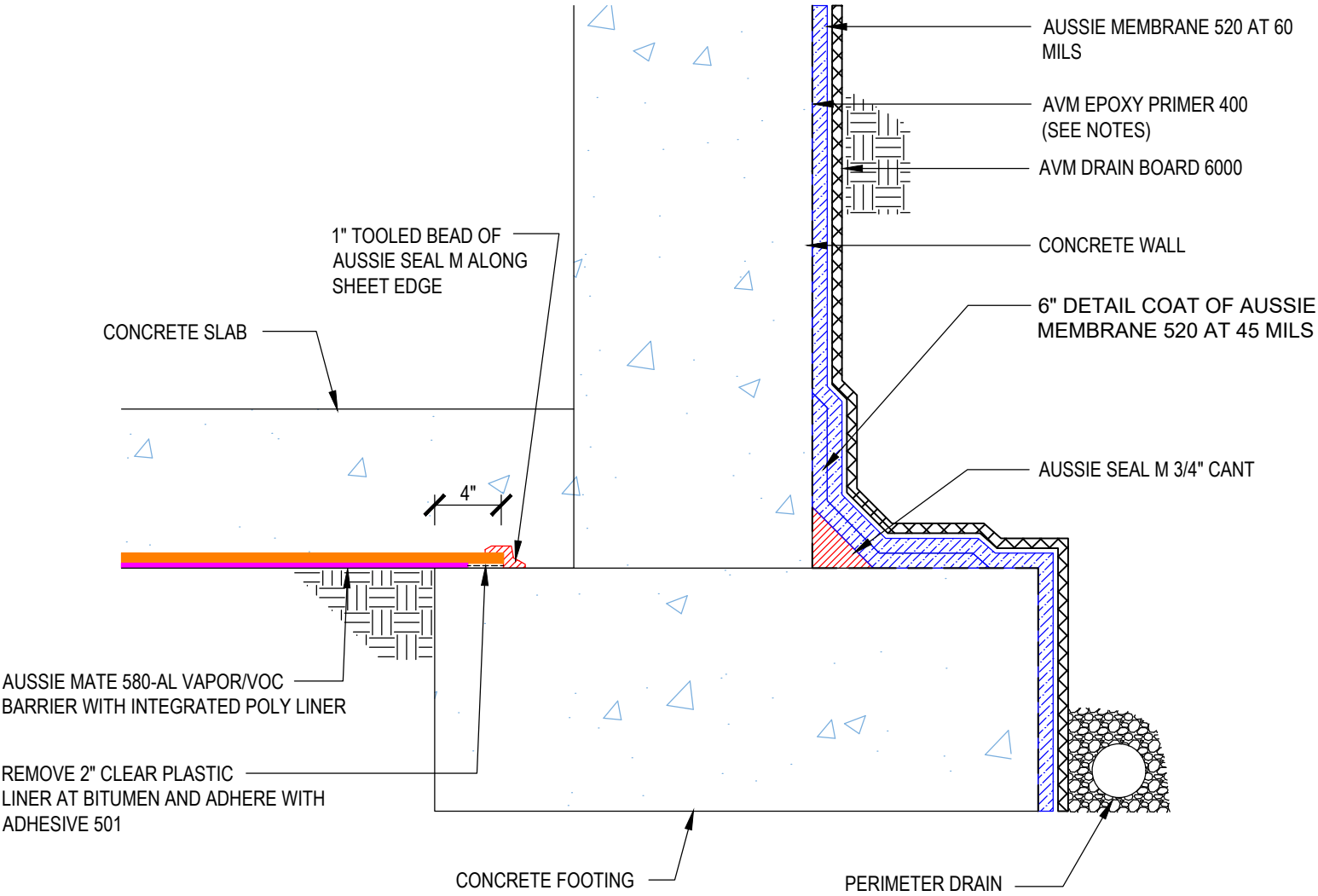

## AUSSIE MEMBRANE 520



**Notes:**

1. Aussie Membrane 520 is a Polyurethane liquid (Roller or Brush Applied) for Below-Grade, Between-Slab, Planters, Roof-Gardens and similar type Waterproofing.
2. Epoxy primer may be required if proper adhesion is not achieved - see installation instructions for further information
3. Contact AVM if no drain board or protection board is specified