

DETAIL #:
 0520-0004
 System:
 Aussie Membrane 520

Transition to Vapor Barrier Flush Footing

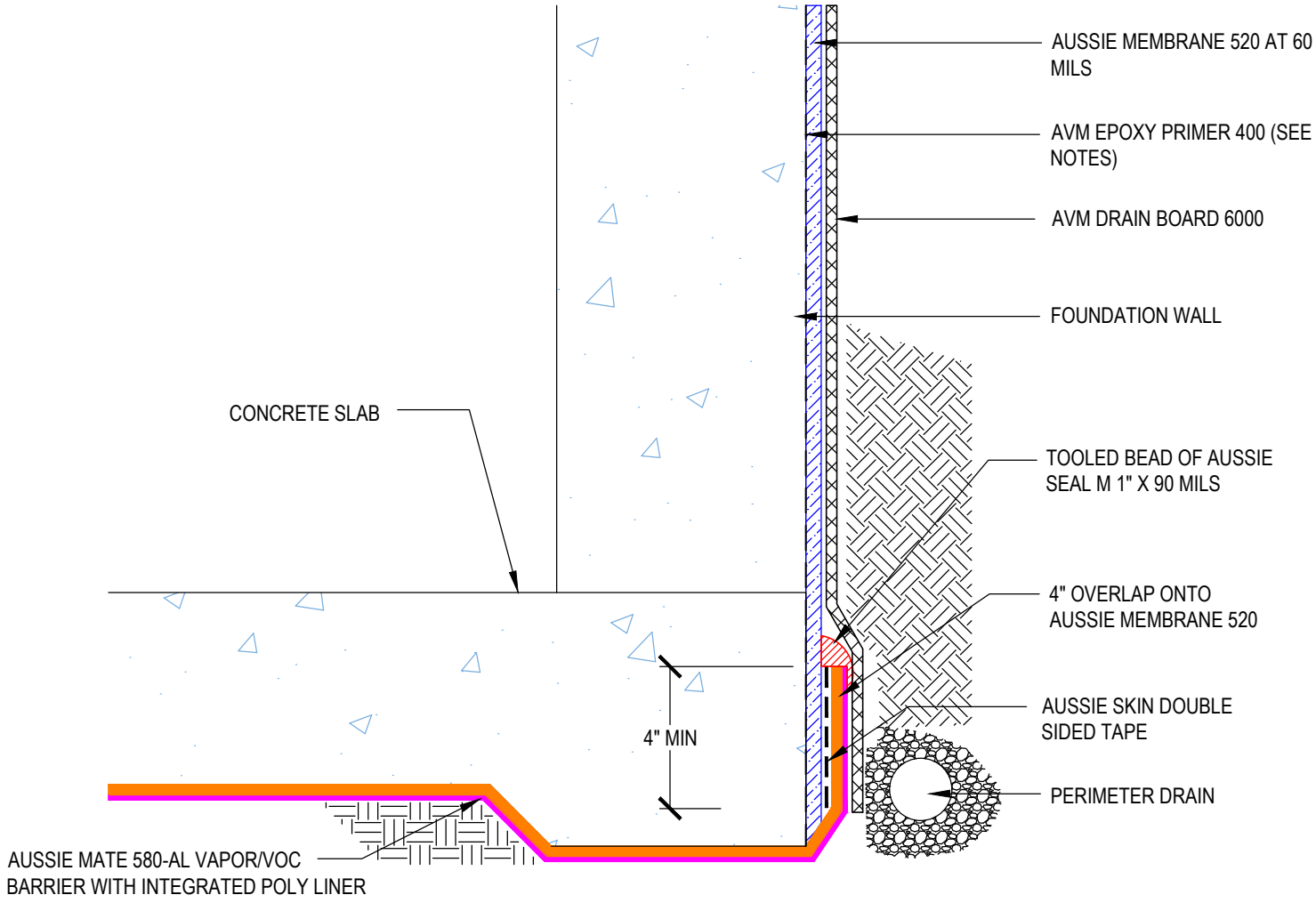

AUSSIE MEMBRANE 520



- Notes:**
1. Aussie Membrane 520 is a Polyurethane liquid (Roller or Brush Applied) for Below-Grade, Between-Slab, Planters, Roof-Gardens and similar type Waterproofing.
 2. Epoxy primer may be required if proper adhesion is not achieved - see installation instructions for further information
 3. Contact AVM if no drain board or protection board is specified