

DETAIL #:
0520-1109
System:
Aussie Membrane 520

Split Slab Edge Termination

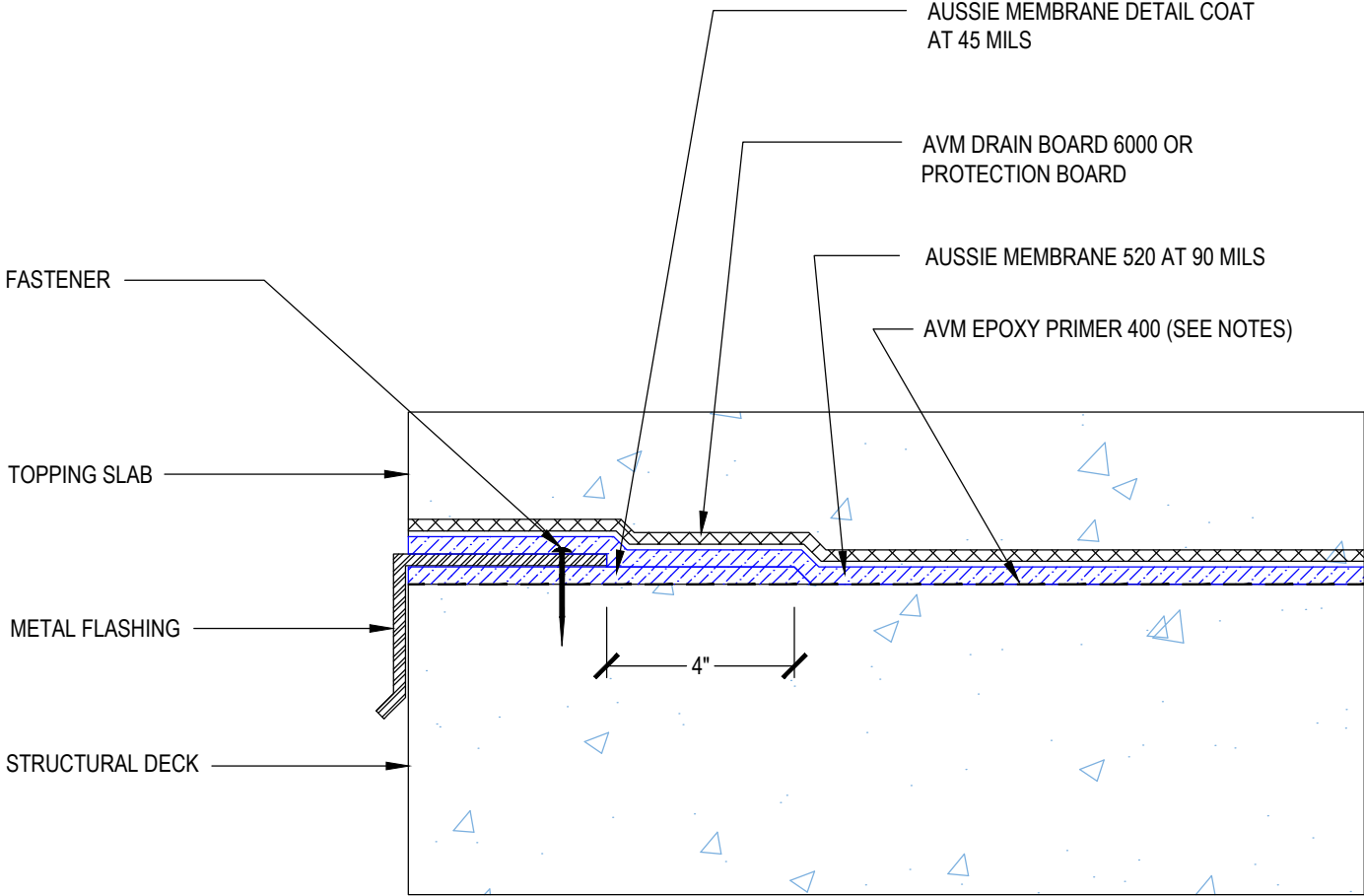

AUSSIE MEMBRANE 520
90 Mil System



Notes:

- 1. Aussie Membrane 520 is a Polyurethane liquid (Roller or Brush Applied) for Below-Grade, Between-Slab, Planters, Roof-Gardens and similar type Waterproofing.
- 2. Epoxy primer may be required if proper adhesion is not achieved - see installation instructions for further information
- 3. Contact AVM if no drain board or protection board is specified