

DETAIL #:
0100-EFD-604-P-CS
 AVM System 100
 Elasto Fiberdeck

Stairs Over Plywood Substrate
AVM Crete on Tread Only
 AVM System 100 Elasto Fiberdeck

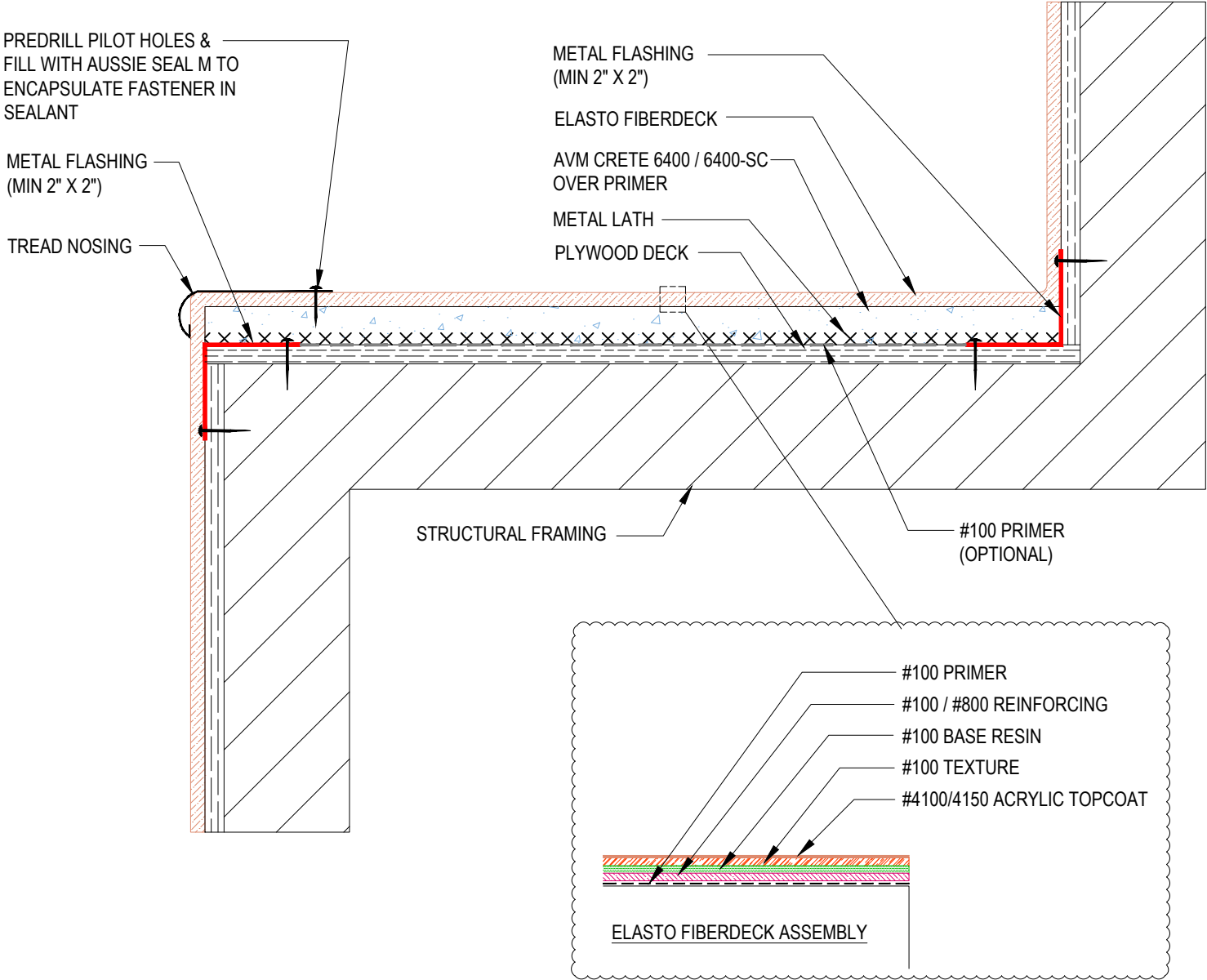

- Notes:**
1. For sheet metal installation please refer to detail # 0100-EFD-621-P-ISO
 2. AVM Crete 6400 - #400 Aggregate with 7400 Additive.
 3. See application instructions for full system recommendations and requirements.