

DETAIL #:
0100-EFD-752-P-CS
 AVM System 100
 Elasto Fiberdeck

Drain Assembly Over Plywood Substrate AVM System 100 Elasto Fiberdeck

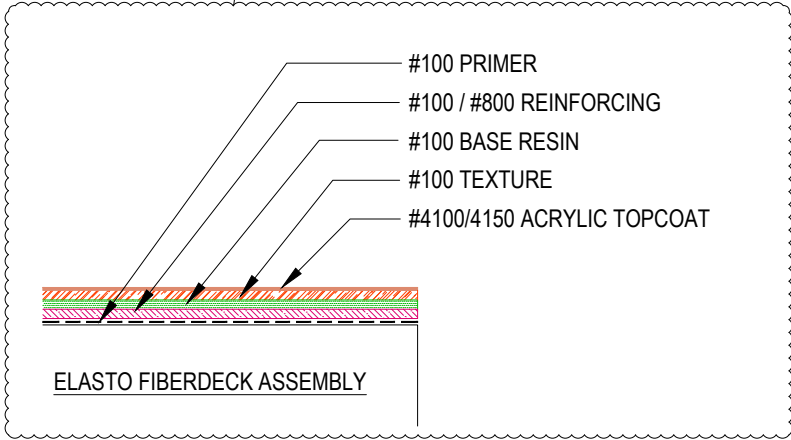
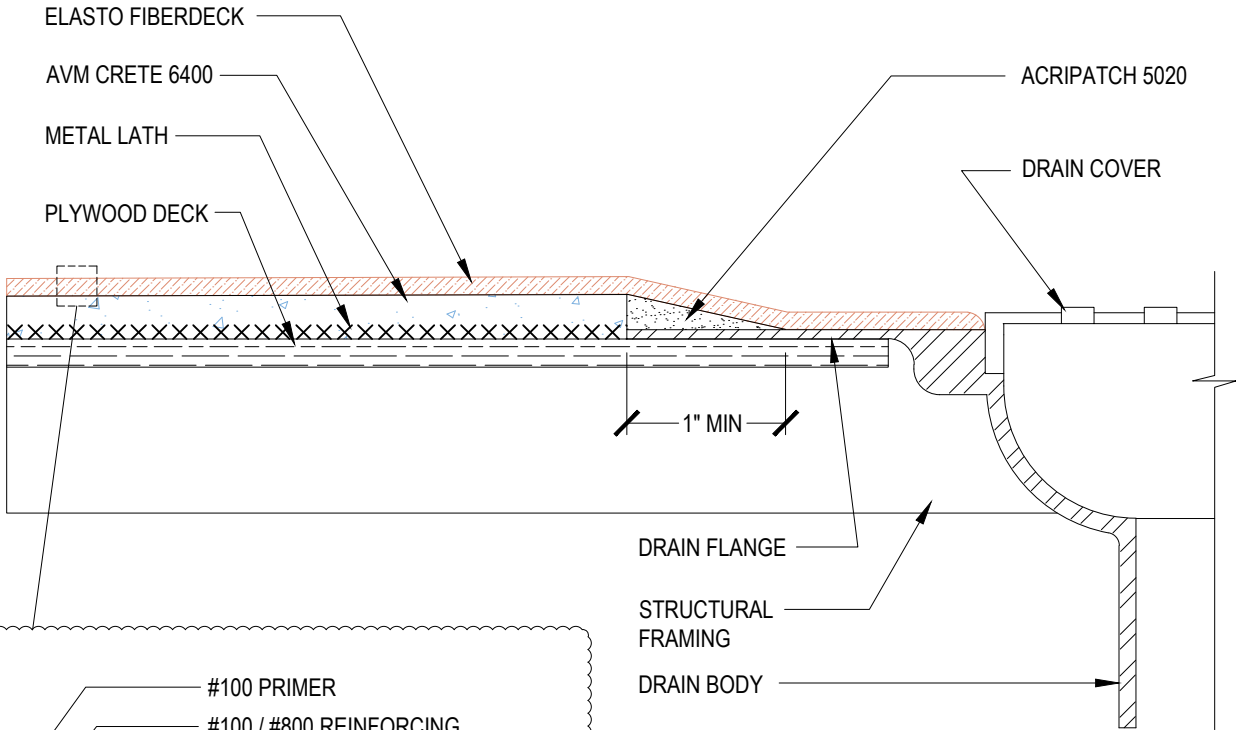

Notes:

1. Stop AVM Crete 6400 at least 2" before drain opening leaving a minimum of 2" exposed flange.
2. Install Acripatch 5020 to transition from Crete 6400 to flange leaving a minimum 1" of flange exposed for direct membrane bonding.
3. Ensure drain sits low enough and that there is sufficient slope to properly drain the water.
4. Drain Flange - Remove all paints, primers, oils or foreign material by abrading / sanding to bare steel prior to full system application.
5. Base resin and reinforcement may be installed into properly repaired drain body.
6. Do not block weep holes.
7. See application instructions for full system recommendations and requirements.