

DETAIL #:  
 0580-AL-0002  
 System:  
 Aussie Mate 580-AL

# Backfilled Wall with Vapor Barrier Under Slab

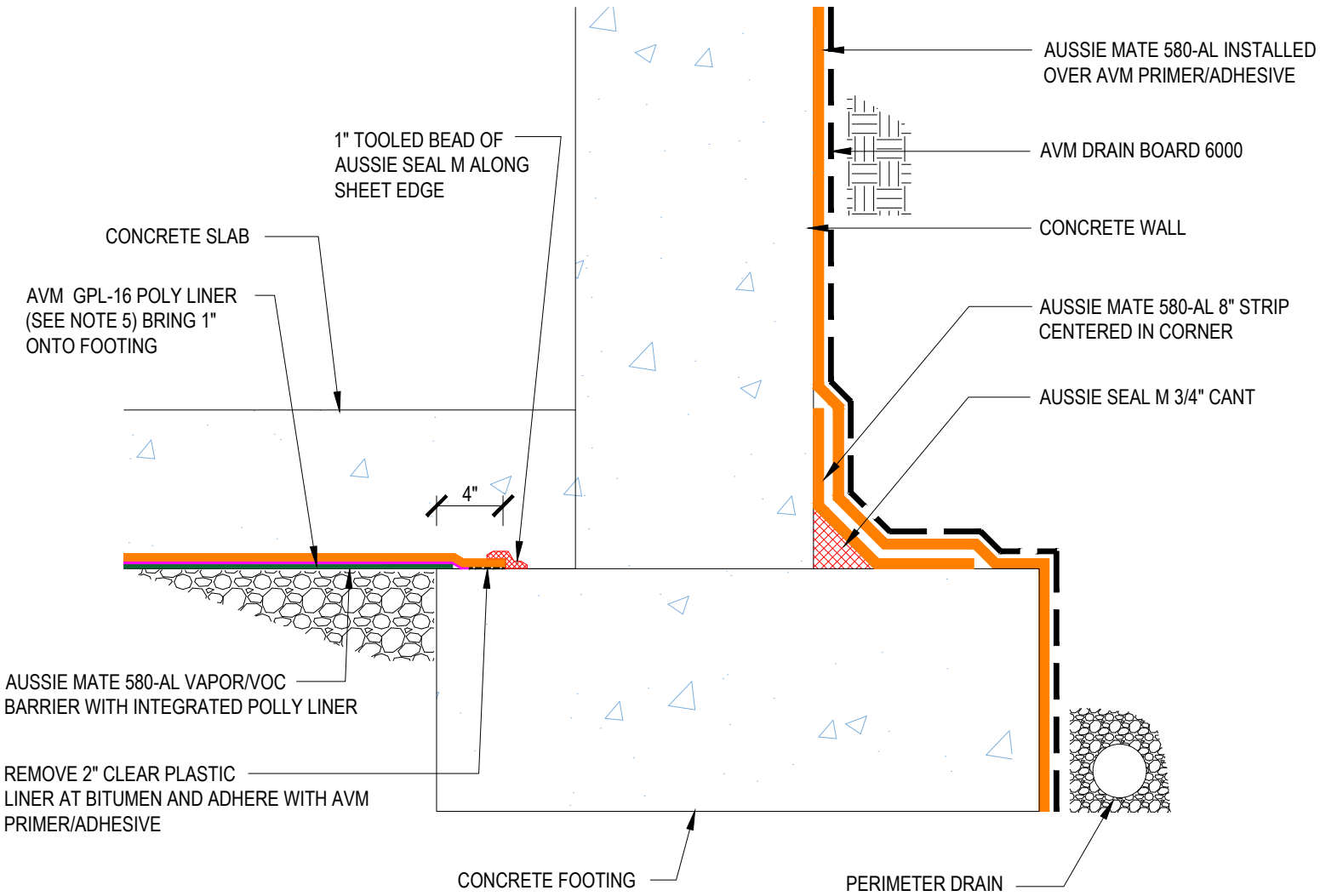

## AVM AUSSIE MATE 580-AL



**Notes:**

1. Aussie Mate 580-AL is an LARR approved Waterproofing membrane and Methane Barrier.
2. Aussie Mate 580-AL is a UV stable, heavy duty bituminous sheet membrane with aluminum protection layer for Below-Grade waterproofing applications and is available in a 60 mil or 80 mil thickness . Aussie Mate 580-AL may also be used as a methane and/or vapor barrier under horizontal slabs on grade.
3. All Aussie Mate overlaps must be minimum 2-1/2" - See "Lapping Details" for more information
4. When installed under slab do not remove integrated poly liner (release liner).
5. GPL-16 is required if the substrate is crushed rock or irregular and is not required with a compacted dirt substrate.