

AVM AUSSIE SKIN ENHANCED LAPS IN SHOTCRETE WATER-TABLE APPLICATIONS

The Aussie Skin 550G/560G Systems are composed of a thick HDPE layer, with dual factory laps and two non-factory lap options that creates excellent adhesion between the membrane and the wet concrete. This prevents water migration from occurring between the system and the concrete. Both Aussie Skin systems are also shotcrete approved and will perform in shotcrete applications as well. However, when using the Aussie Skin systems in shotcrete applications when exposed to hydrostatic conditions, AVM has enhanced the lap detailing to ensure the Aussie Skin systems perform and protect the structural integrity of the building. Below are the ways AVM has enhanced both the factory and non-factory laps in hydrostatic shotcrete applications. AVM Aussie Clay 590/590-PL is also required in shotcrete hydrostatic applications.

FACTORY LAPS

Option 1: In addition to the standard factory lap detailing for AVM Aussie Skin systems, factory laps must be sealed using Aussie Skin Sanded Tape centered over the Aussie Skin factory seam. The Aussie Skin Sanded Tape must be installed using a heat gun or torch to melt the adhesive around the granules as shown below:

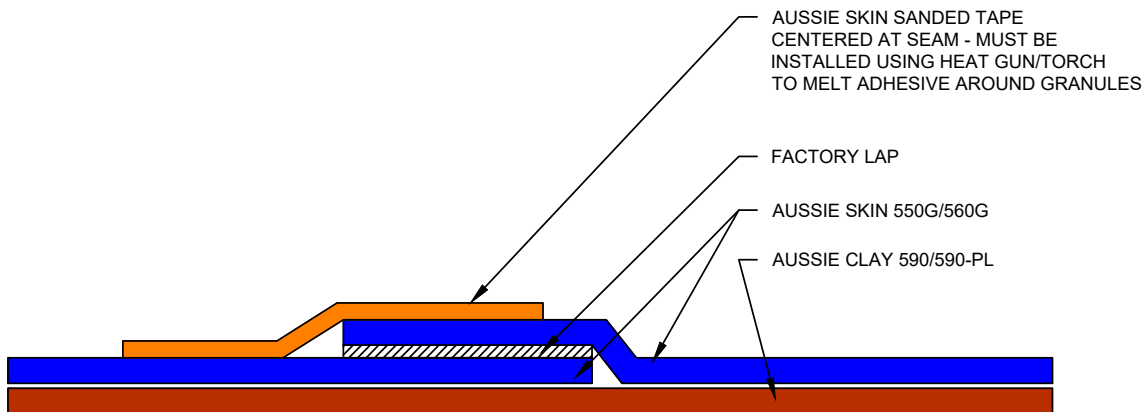

Option 2: In addition to the standard factory lap detailing for AVM Aussie Skin systems, factory laps must be sealed using Aussie Skin Sanded Tape wet set into sealant and centered over seam as shown below:

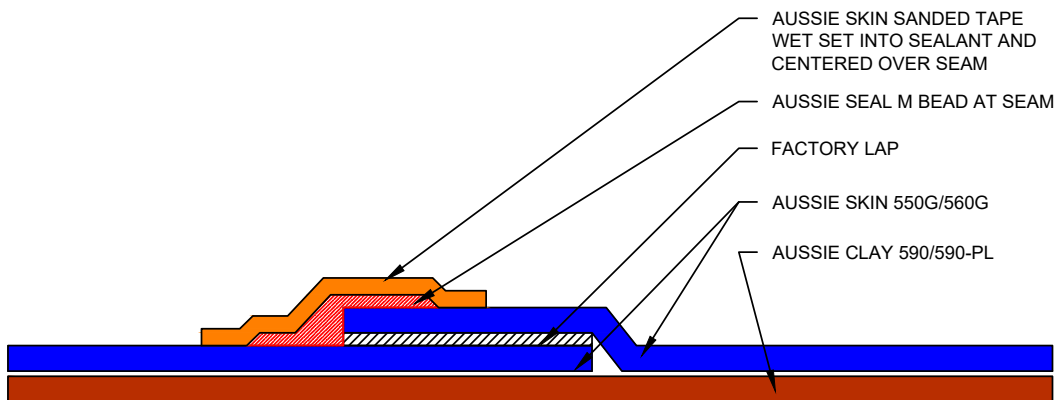

NON-FACTORY LAPS

All Non-Factory laps must utilize both the Aussie Skin Double-Sided Tape/Aussie Skin Detail Strip and the Aussie Skin Sanded Tape centered over the seam. The seam can be wet set into a bead of Aussie Seal M or heated by using a heat gun/torch to melt the granules. Below will show both details with both Double-Sided Tape and the Detail Strip:

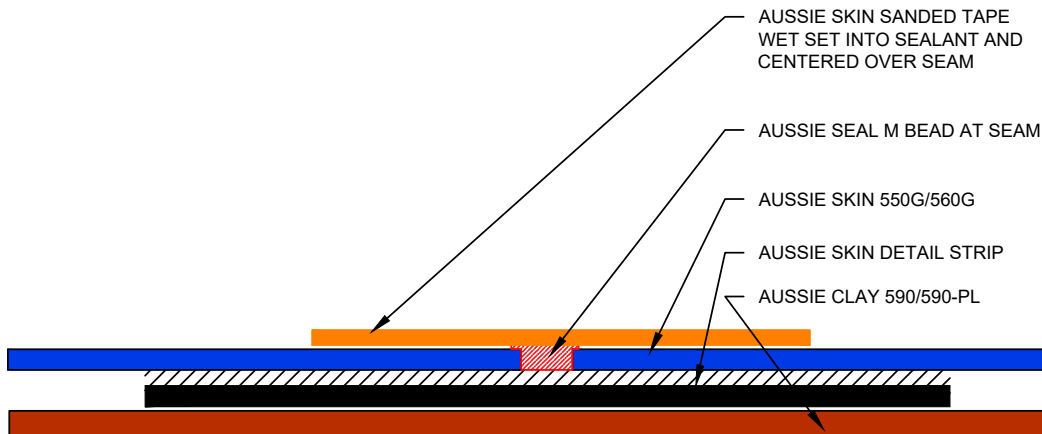
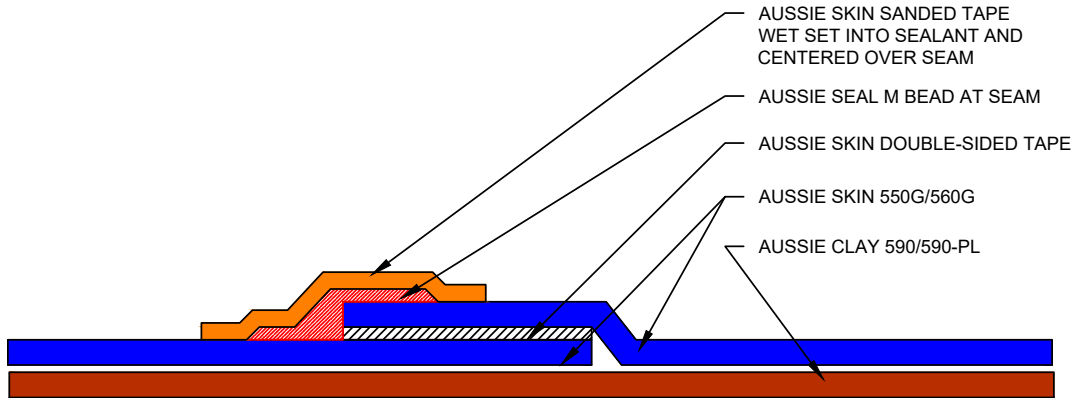

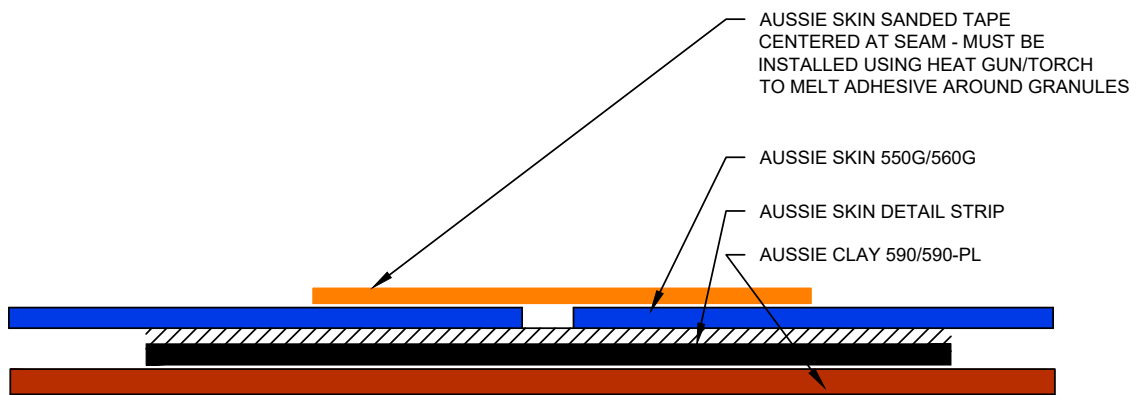
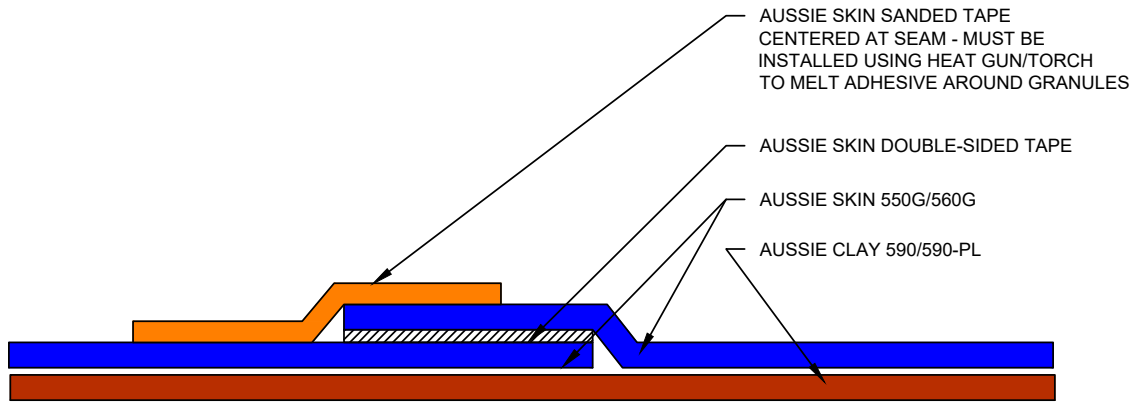

For additional or specific questions regarding concrete splatter on the Aussie Skin membrane, please consult your local AVM Sales Representative or the Technical Services Department at: **888.414.1041** or **818.888.0050**.