

AUSSIE SKIN 550G/560G – Repair Guidelines

AVM's Aussie Skin 550G/560G is composed of a thick heavy-duty HDPE film with an adhesive granulated surface that forms a robust bond with concrete when it is poured against it. The membrane relies on this bond to function as designed to create a unique and strong waterproofing in pre-applied applications (blindside and underslab).

Because the membranes are installed in a pre-applied application, there poses a risk of damage prior to concrete coverage. Proper site preparation, communication between the construction team, and protecting the waterproofing contractor's work all contribute to successful installation of the Aussie Skin 550G/560G membranes. In the event that the membrane is damaged, the below guideline can be followed to ensure the membrane is repaired properly prior to coverage.

When to Repair

Designed with the thick heavy-duty HDPE layer, AVM's Aussie Skin 550G/560G membranes can be subjected to typical construction activity/traffic prior to concrete coverage without requiring repairs in most circumstances. There is always risk, however, that construction traffic/activity can result in damage to the membrane which will require repairs prior to concrete coverage for the system to properly work. These necessary repairs often depend on the degree of damage that has occurred to the membrane and whether the installation sits in the water table (hydrostatic is present). Common causes of damage can be:

- Careless placement or movement of rebar or reinforcing over the membrane
- Construction activities occurring near the membrane (torching piles, placing formwork/steel, chipping concrete, etc.)
- Construction materials placed/dropped onto the membrane (steel, sharp tools, adhesives/chemicals, etc.)

Be aware of when these activities take place and be sure to check the membrane for any gashes, slices, punctures, tears, corrosion, etc. If any of the above is noted, the membrane will need to be repaired.

Repair Procedures

- Slice in the membrane
 - Wire brush area to remove loose granules
 - Install Aussie double sided tape centered over the slice and roll into place
 - Install Aussie Skin piece (same size as taped area) over the double-sided tape and roll into place
- Large area of damage or a cutout area from a misplaced penetration
 - Wire brush area to remove loose granules 4" around the extent of the damage
 - Install Aussie double sided tape (4") around damaged area onto sound Aussie Skin
 - Cut and install Aussie Skin patch and roll into place
- Small punctures, nail holes, etc. (non-water table)
 - Wire brush area to remove loose granules
 - Install Aussie Skin Sanded tape (4" x 4") over the area
- Small punctures, nail holes, etc. (Water table and/or underslab)
 - Wire brush area to remove loose granules
 - Install a 2" wide bead of Aussie Seal M over puncture or fastener
 - Wet-set a (4" X 4") piece of Aussie Skin Sanded Tape and roll into place

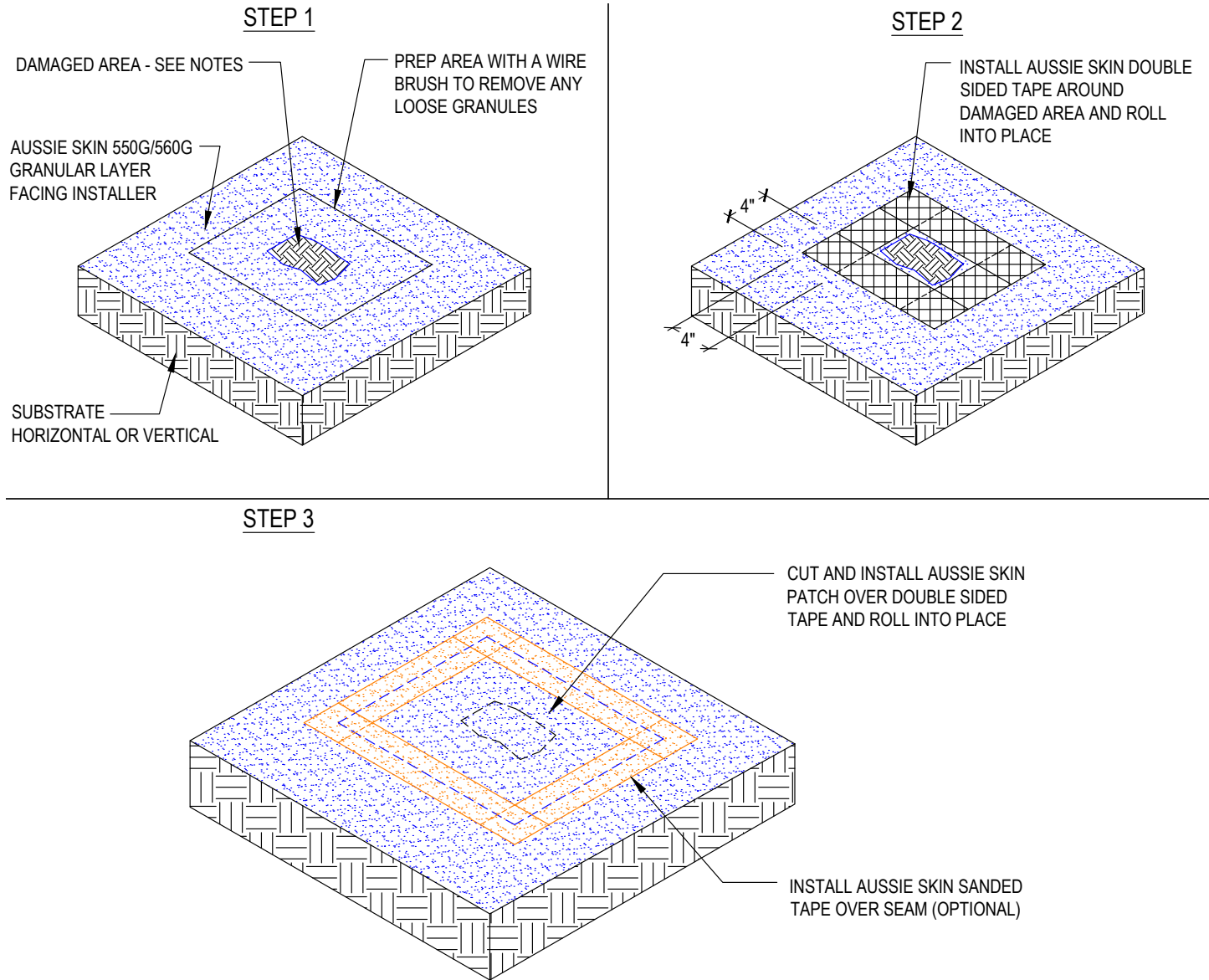
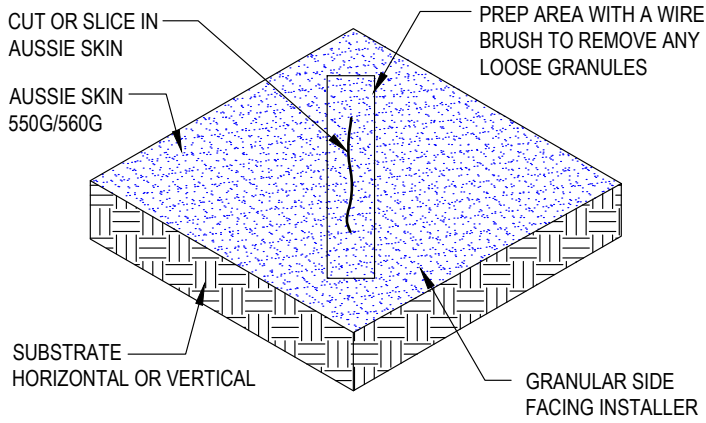

Figure 1 - Repair Procedure for Large Areas of Damage - Sande Side

CUTS & SLICES - STEP 1



CUTS & SLICES - STEP 2

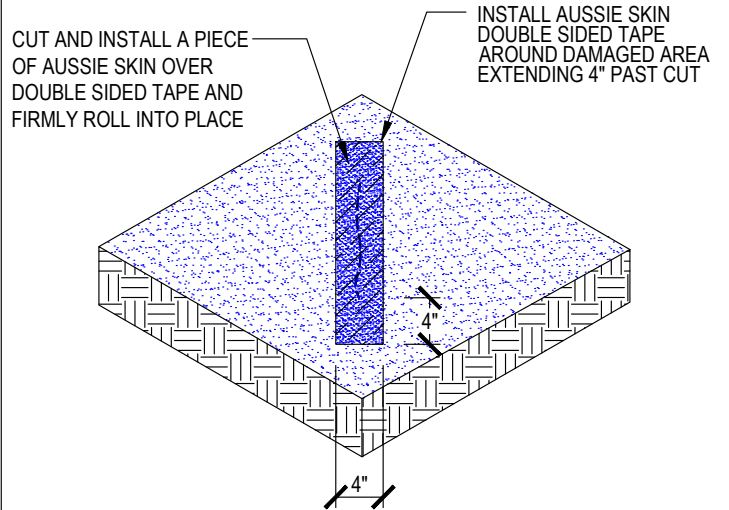
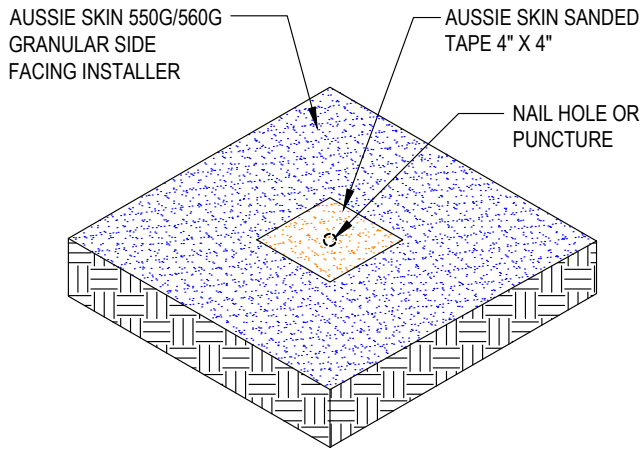

Figure 2 – Repairs to Cuts & Slices

PUNCTURES / FASTENERS - NON-WATER TABLE



PUNCTURES/FASTENERS - WATER TABLE OR UNDER-SLAB

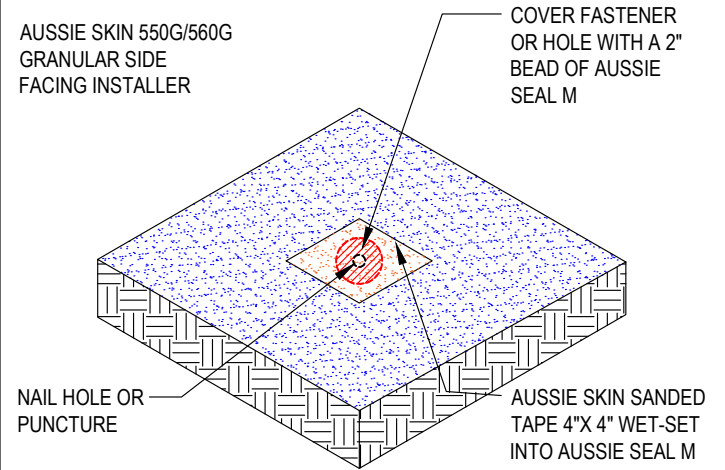

Figure 3 – Puncture Damage in Non-Water Table & Water Table Applications

For additional or specific questions regarding pre-hydration of the Aussie Clay 590, please consult your local AVM Sales Representative or the Technical Services department at: **888.414.1041** or **818.888.0050**.