



Aussie Membrane 500

Heavy Duty Below Grade Bituminous Waterproofing Membrane

Sections 071000 / 071400 / 071416
Fluid Applied Waterproofing

Product Name

Aussie Membrane 500
AVM System 500

Manufactured by

AVM Industries, Inc.
8245 Remmet Ave, Canoga Park, CA 91304
888.414.1041 818.888.0050
www.avmindustries.com

Product Description

The **AVM Aussie Membrane 500** is a Water-Based rubber/bitumen liquid membrane modified with high performance rubberized polymers giving it excellent adhesion, which dries to a tough, black seamless flexible waterproof membrane. The **Aussie Membrane 500** is a single component thixotropic cold-applied bitumen paste that exhibits excellent elongation and recovery properties. The **AVM Aussie Membrane 500** has excellent long-term stability (maintains its properties over very long periods of time) un-like other below grade systems (including polyurethane based systems) that Crack and become brittle as they age.

Where to Use

Below-Grade: Foundation Walls (Concrete & CMU), Retaining Walls, Basements

Decks & Planters: Plaza Decks, Split-Slab Decks, Planter Boxes

Converting Aussie Membrane 500 to a Trowel Grade or a Patch Material:
See bottom of page 2.

Warranty

AVM Industries will warranty the installed membrane for a period of five (5) years. Ten (10) year warranties are also available. For complete warranty details, contact AVM Industries or consult with your applicator.



Delivery, Storage, and Handling

- Delivery of all the AVM System 500 materials to the job site must be in their original sealed containers, with manufacturer's name and label intact.
- Handle and store containers in accordance with printed instructions.
- Store at temperatures between 50°F and 90°F. Do not store materials in direct sunlight or where they may be damaged by water or rain.
- Failure to comply with the recommended storage conditions may result in premature deterioration of the product. For specific storage advice, please contact AVM Industries and/or its representatives.
- Keep all materials out of the reach of children.
- If irritation occurs during use, liberally flush affected areas with water. If irritation continues, see a physician immediately.

Project Conditions

- All surfaces to which the **Aussie Membrane 500** is applied to must be sound and stable, with an even finish and free from dust, loose debris, grease, curing agents, etc.
- The **Aussie Membrane 500** may be applied to damp but not waterlogged surfaces (Green Concrete)
- Do not apply materials at temperatures below 40°F and falling or if precipitation is imminent. Do not apply materials in direct sunlight at temperatures above 100°F or rising.
- Warn personnel against hazards of materials to skin and eyes. Note other hazardous conditions on the job that might require special protective gear and or any other special protective or safety procedures.
- Protect adjacent surfaces which could be damaged during the application procedure.
- This system must not be used to cover Expansion Joints.

System Application

Read the AVM System 500 Installation Instructions Prior to Installation. Application instructions vary based on type of application and the type of surfaces it's being applied to. For specific application procedures, refer to, or download the appropriate installation instructions. (For Retaining Walls, refer to the "Retaining Walls Installation Instructions". For Planters, refer to the "Planters Installation Instructions", etc.)

Basic installation procedures are also provided in the "Spec Data Sheet" of each type of installation. For a complete/comprehensive set of instructions, however, please refer to the "Installation Instructions" documents.

Quality Control

- Visually inspect all coated surfaces to ensure a full and proper coating application, especially at corners, drainage footings and other hard-to-reach areas.
- All unsatisfactory areas shall be repaired prior to final acceptance.

Protection of Installed Work

- The completed section shall be protected for the first 24 hours after application or until the surface is sufficiently cured. (The amount of drying time may vary depending on temperature and humidity conditions)
- Always protect the waterproofing from possible damage. Use AVM Drainboard or an approved Foam Board/Protective Panel. Refer to the "Tech Data Sheets" for protection details.

Availability and Cost

Contact AVM Industries or your approved applicator for pricing and availability.

Technical Services

Technical services are available by contacting our offices at: **888.414.1041** or **818.888.0050** or visit **www.avmindustries.com**

System Specifications

See next page.

The following coverages are based on controlled tests. Actual coverages may vary.

| Technical Information | | |
|---|---|-------------|
| Color | Dark brown. After drying: black | |
| Specific Gravity | 1.189 gr/cm ² | |
| Coverage: (Varies depending on substrate) | 18 sq.ft./Gal. (90 sq.ft./Bucket) @ 60 Dry Mills | |
| Flash Point | Non-flammable | |
| Service Temperature | 15°F-177°F (-10°C to +80°C) | |
| Application Temperature | 42°F-132°F (+5°C to 55°C) | |
| Solid Content | 64% | |
| Tensile Strength | >15.4 Lbs (>7 kg) | ASTM D 412 |
| Elongation at break | >1000% | ASTM D 412 |
| Resistance to water pressure 1 tm 24 hr | Passed | ASTM D751 |
| Water vapor transmission | 4.0 gr/m ² 24 hr | ASTM D 96 |
| Recovery | 85% | IS 1536 |
| Creep At 177°F (80°C) | No Creep | DIN 52123 |
| Resistance to Standing Water | Passed | ASTM D 2939 |
| Bacterial Attack in soil 30 days @ 105°F (40°C) | Passed | ASTM D 2939 |
| Crack bridging | >3/16" (>5mm) | IS 1731 |
| Certifications | ISO 9002, Green Label, I.Q. Net (International Certification Network) | |

| Item / Component | Packaging | Approx Shipping Weights | VOC |
|-------------------------|----------------|-------------------------|----------------|
| AVM Aussie Membrane 500 | 5.0 gal. pails | 5.0 gal. 52.5 lbs | 19 Grams/Liter |

Converting Aussie Membrane 500 to a Trowel Grade or a Bituminous Patch Material:

Aussie Powder 500 (Sold Separately) is used to create a trowel-grade product when thicker coats are required (Such as when applying on vertical surfaces) or to create a bituminous patch material suitable for patching and detailing.

Mixing Ratio

Add Aussie Powder 500 to **Aussie Membrane 500**. The typical ratios are:

1-Gallon Membrane: Add 2 scoops for Trowel Grade and 4 scoops for Bituminous Patch.

5-Gallon Membrane: Add 1 Jar (1 kg) for Trowel Grade and 2 Jars (2 Kg) for Bituminous Patch.

Mixing Instructions

Gradually add the powder to the membrane while stirring continuously. Mix until a smooth consistency is achieved.

Application

Apply the trowel-grade mixture with a brush or roller. Apply the Patch Material with a suitable tool for inside corners, patching, and detailing.

Additional Notes

Adjust the amount of powder to achieve the desired patch consistency. For Trowel Grade Membranes, do NOT add more than the recommended amount.

Pot Life: The pot life of the mixed product (Powder + **Aussie Membrane 500**) may vary based on temperature, humidity, and qty of powder used. Pot life could be as short as 15-20 minutes.

Retaining Wall with Aussie Membrane

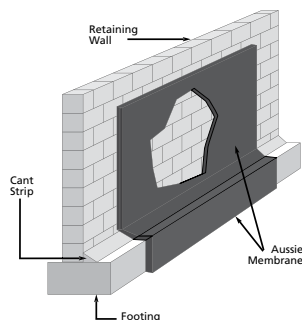

Planter with Aussie Membrane

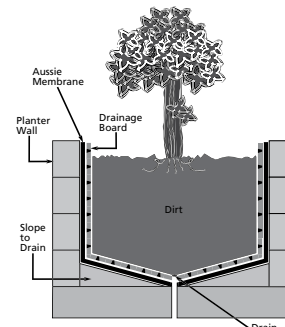

For a complete list of details in CAD or PDF, please visit our website at www.avmindustries.com.

AVM Industries, Inc.
8245 Remmet Ave, Canoga Park, CA 91304
888.414.1041 818.888.0050

Quality Waterproofing Products



www.avmindustries.com